

SITE PLAN OF PART OF LOT 8, BLOCK 14, SECTION 11, ESQUIMALT DISTRICT, PLAN 195A.

PID 009-289-810

Date: 2026-02-04
File: 4742-01
Drawing: 4742-01_MS-SITE.dwg
Layout: B-Landscape

POLARIS
LAND SURVEYING

Mailing & delivery address: Polaris Land Surveying 2024 Inc.
Suite 138, 2223A Oak Bay Avenue
Victoria, BC, V8R 1G4
Toll Free: (877) 603 7398
Telephone: (250) 412 3513
info@plsi.ca
www.plsi.ca



The intended plot size of this plan is 432mm in width by 280mm in height (B-size) when plotted at a scale of 1:300.

All distances and elevations are in metres and decimals thereof, unless otherwise noted.

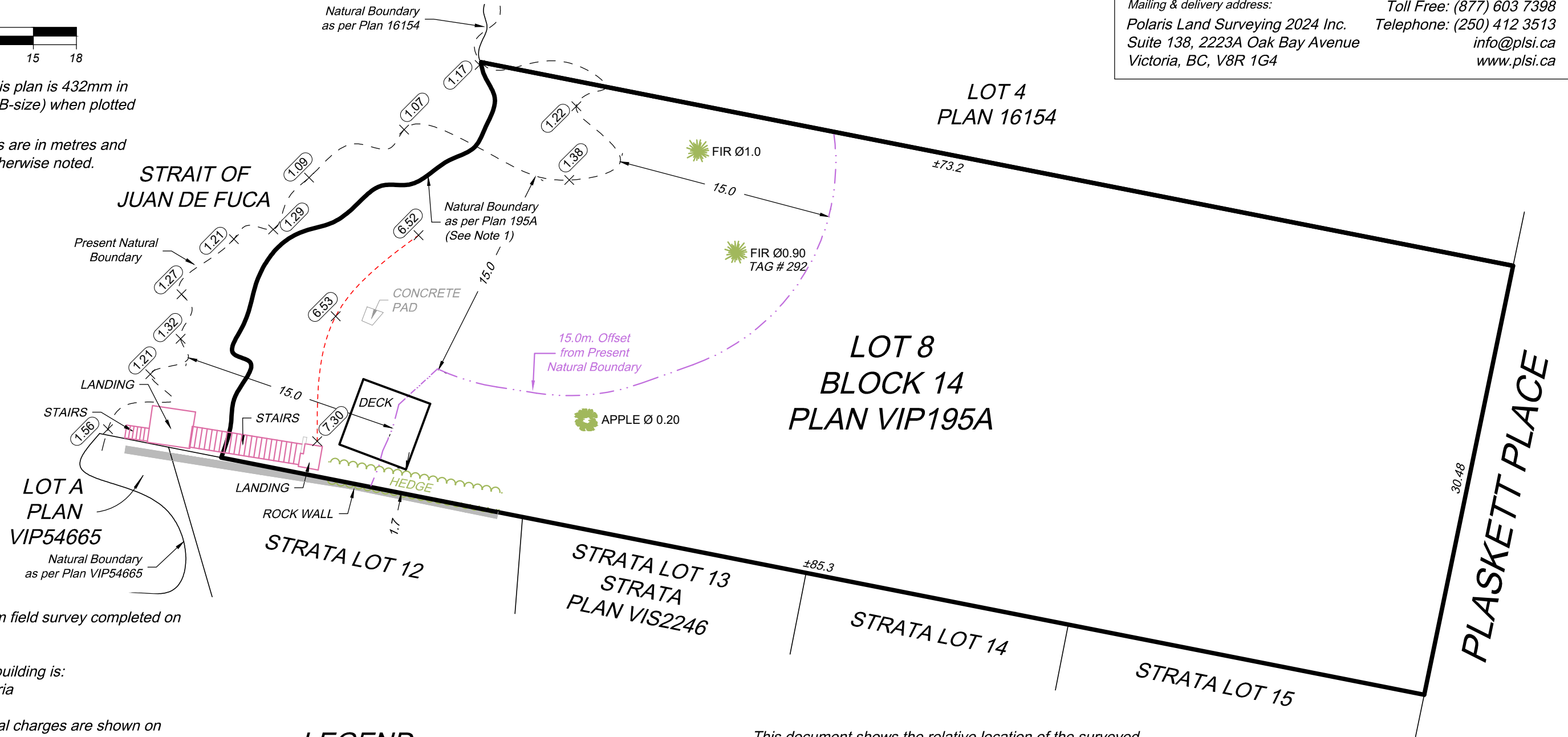
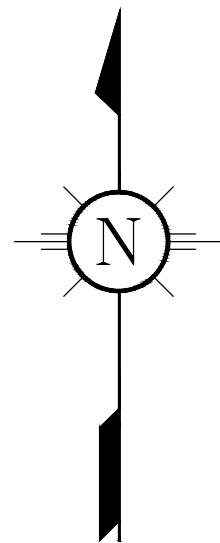

Setbacks are derived from field survey completed on February 3, 2026.

The civic address of the building is:
322 Plaskett Place, Victoria

The following non-financial charges are shown on the current Certificate of Title and may affect the property:

M76301 - UNDERSURFACE RIGHTS
79769G - UNDERSURFACE RIGHTS

This Plan was prepared for discussion purposes and is for the exclusive use of Suzanne Marie Smith.

Elevations are referred to the CGVD28 Datum and are derived from Control Monument 84H0167 with an elevation of 12.295 metres.

Tree species and diameter are estimated and should be confirmed by a Certified Arborist.

Additional buildings or structures not shown on this plan may be located on the property.

LEGEND

- denotes Spot Elevation
- denotes Tree - Coniferous
- denotes Tree - Deciduous
- denotes Top of Bank
- denotes Treeline/Bushline

Note 1

This plan shows the natural boundary according to plans 195A, VIP54665 and 16154 and an opinion on the location of the present natural boundary based on field survey. The natural boundary according to Plan 195A may not reflect the current extent of title.

This document shows the relative location of the surveyed buildings and features with respect to the boundaries of the parcel described hereon. This document shall not be used to define property lines or property corners.

Polaris Land Surveying 2024 Inc. accepts no responsibility or liability for any damages that may be suffered by a third party as a result of any decisions made, or actions taken based on this document.

© Polaris Land Surveying 2024 Inc. 2026. All rights reserved. No person may copy, reproduce, transmit or alter this document, in whole or in part, without the express written consent of Polaris Land Surveying 2024 Inc. .

Certified Correct as to the practice of land surveying in accordance with Part 11-5(2) of the Survey and Plan Rules as of the 3rd day of February, 2026.

Odysseas Christodoulou, BCLS 1078