

DEVONSHIRE RD INVESTIGATIVE WORK

STA (1+010.00 - 1+688.50)



LOCATION PLAN

SCALE 1 : 4000

DRAWING INDEX

DRAWING No.	SHEET No.	DRAWING TITLE	REVISION No.
ESQ - M000	1	LOCATION PLAN	0
ESQ - M100	2	SEWER IDENTIFIER STA (1+010.00 - 1+165.00)	0
ESQ - M101	3	SEWER IDENTIFIER STA (1+165.00 - 1+336.00)	0
ESQ - M102	4	SEWER IDENTIFIER STA (1+336.00 - 1+520.00)	0
ESQ - M103	5	SEWER IDENTIFIER STA (1+520.00 - 1+688.50)	0
ESQ - M200	6	DRAIN IDENTIFIER STA (1+033.10 - 1+165.00)	0
ESQ - M201	7	DRAIN IDENTIFIER STA (1+165.00 - 1+336.00)	0
ESQ - M202	8	DRAIN IDENTIFIER STA (1+336.00 - 1+520.00)	0
ESQ - M203	9	DRAIN IDENTIFIER STA (1+520.00 - 1+658.00)	0
ESQ - M300	10	COMBINED UTILITIES STA (1+010.00 - 1+165.00)	0
ESQ - M301	11	COMBINED UTILITIES STA (1+165.00 - 1+336.00)	0
ESQ - M302	12	COMBINED UTILITIES STA (1+336.00 - 1+520.00)	0
ESQ - M303	13	COMBINED UTILITIES STA (1+520.00 - 1+688.50)	0
ESQ - M400	14	ROAD CORRIDOR IDENTIFIER STA (1+336.00 - 1+520.00)	0
ESQ - M401	15	ROAD CORRIDOR IDENTIFIER STA (1+520.00 - 1+658.00)	0

DISCLAIMER:
 LOCATION OF UTILITIES SHOWN ARE APPROXIMATE ONLY AND SHOULD BE CONFIRMED BY FIELD SURVEY AND BY USE OF A PIPE LOCATOR AND MANUAL DIGGING WHERE REQUIRED. EXISTING SERVICE LOCATIONS ARE SHOWN TO INDICATE THE EXISTENCE OF THE SPECIFIED SERVICE ONLY AND ARE NOT NECESSARILY COMPLETE OR SHOWN IN THE CORRECT LOCATION. IT IS THE CONTRACTOR'S RESPONSIBILITY TO LOCATE, VERIFY THE INVERT ELEVATIONS BY HAND EXCAVATION BEFORE CONSTRUCTION OF THE UTILITY CROSSING AND SHALL BE RESPONSIBLE FOR ADEQUATE PROTECTION FROM DAMAGE AT CONTRACTOR'S COST

LEGEND:

- SMH#### = IDENTIFIER CODE FOR SEWER MANHOLE STRUCTURE
- SLC#### = IDENTIFIER CODE FOR SEWER SERVICE LATERAL CONNECTION
- SGM#### = IDENTIFIER CODE FOR GRAVITY TYPE SEWER MAIN PIPE
- SIC#### = IDENTIFIER CODE FOR SEWER INSPECTION CHAMBER

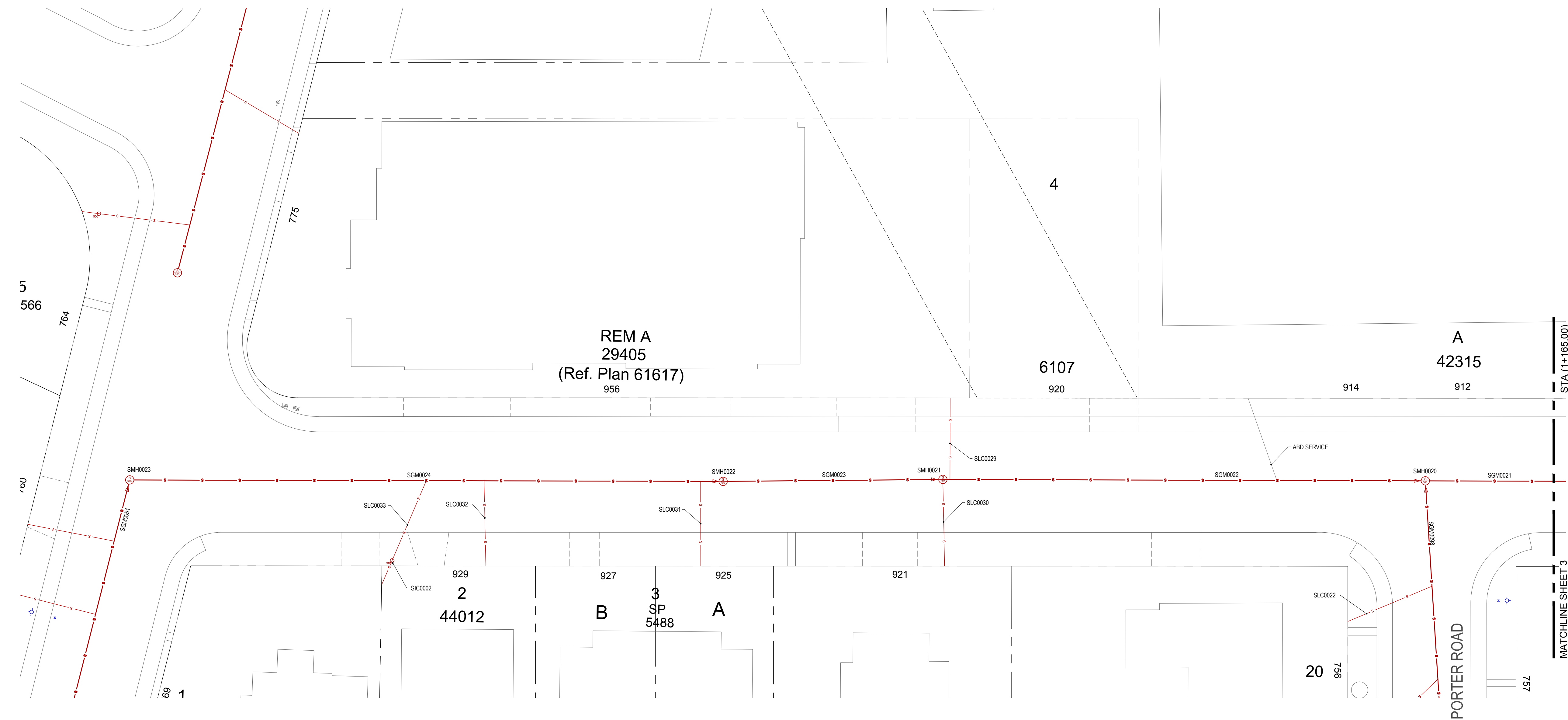
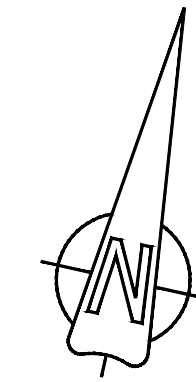

CONFIRM
 UNDERGROUND
 LOCATIONS WITH
 UTILITY COMPANIES

LEGEND - Existing services shown solid	
CABLE —TV—	TEL POLE T
DRAIN —D—	SURVEY MONUMENT ⊕
GAS —GAS—	IRON PIN IP
SEWER —S—	LEAD PLUG LP
WATER —W—	TRAVERSE HUB
ELECTRICAL —E—	P.K. NAIL PK
SIDEWALK S/W	
TREE	
DRAIN MANHOLE	
CATCH BASIN	
GAS VALVE	
GAS SNIFFER	
SEWER MANHOLE	
SEWER LAMPHOLE	
WATER VALVE	
FIRE HYDRANT	
ELECTRIC POLE E	
TEL POLE T	
SURVEY MONUMENT ⊕	
IRON PIN IP	
LEAD PLUG LP	
TRAVERSE HUB	
P.K. NAIL PK	
DRAIN CLEANOUT DCO	
DRAIN VENT DV	
STREET LIGHT	
GAS METER	
SEWER CLEANOUT SCO	
SEWER VENT SV	
WATER METER	
SERVICE VALVE	

REVISIONS	REVISIONS APPROVED			DESIGN APPROVED		
	APP.	DATE	SIGN	APP.	DATE	SIGN
ISSUED FOR REVIEW						

DESIGN APPROVED			TOWNSHIP OF ESQUIMALT		
EXCEPTIONS	DATE	SIGN	DEVONSHIRE ROAD INVESTIGATIVE WORK		
DESIGN ENG.	17.02.10	WW	SEWER IDENTIFIER STA (1+010.00 - 1+165.00)		
ASSIST. ENG.			CONTROL MONUMENTS		
MUNICIPAL ENG.			DESIGN EFS	DRAWN EFS	SURVEY HH
			SCALES: H=1:250		DATE 2017.02.10

DESIGN DWG. NO. ESQ-M100
 Sheet # 2

DISCLAIMER:
 LOCATION OF UTILITIES SHOWN ARE APPROXIMATE ONLY AND SHOULD BE CONFIRMED BY FIELD SURVEY AND BY USE OF A PIPE LOCATOR AND MANUAL DIGGING WHERE REQUIRED. EXISTING SERVICE LOCATIONS ARE SHOWN TO INDICATE THE EXISTENCE OF THE SPECIFIED SERVICE ONLY AND ARE NOT NECESSARILY COMPLETE OR SHOWN IN THE CORRECT LOCATION. IT IS THE CONTRACTOR'S RESPONSIBILITY TO LOCATE, VERIFY THE INVERT ELEVATIONS BY HAND EXCAVATION BEFORE CONSTRUCTION OF THE UTILITY CROSSING AND SHALL BE RESPONSIBLE FOR ADEQUATE PROTECTION FROM DAMAGE AT CONTRACTOR'S COST

LEGEND:

- SM##### = IDENTIFIER CODE FOR SEWER MANHOLE STRUCTURE
- SLC#### = IDENTIFIER CODE FOR SEWER SERVICE LATERAL CONNECTION
- SGM#### = IDENTIFIER CODE FOR GRAVITY TYPE SEWER MAIN PIPE
- SIC#### = IDENTIFIER CODE FOR SEWER INSPECTION CHAMBER

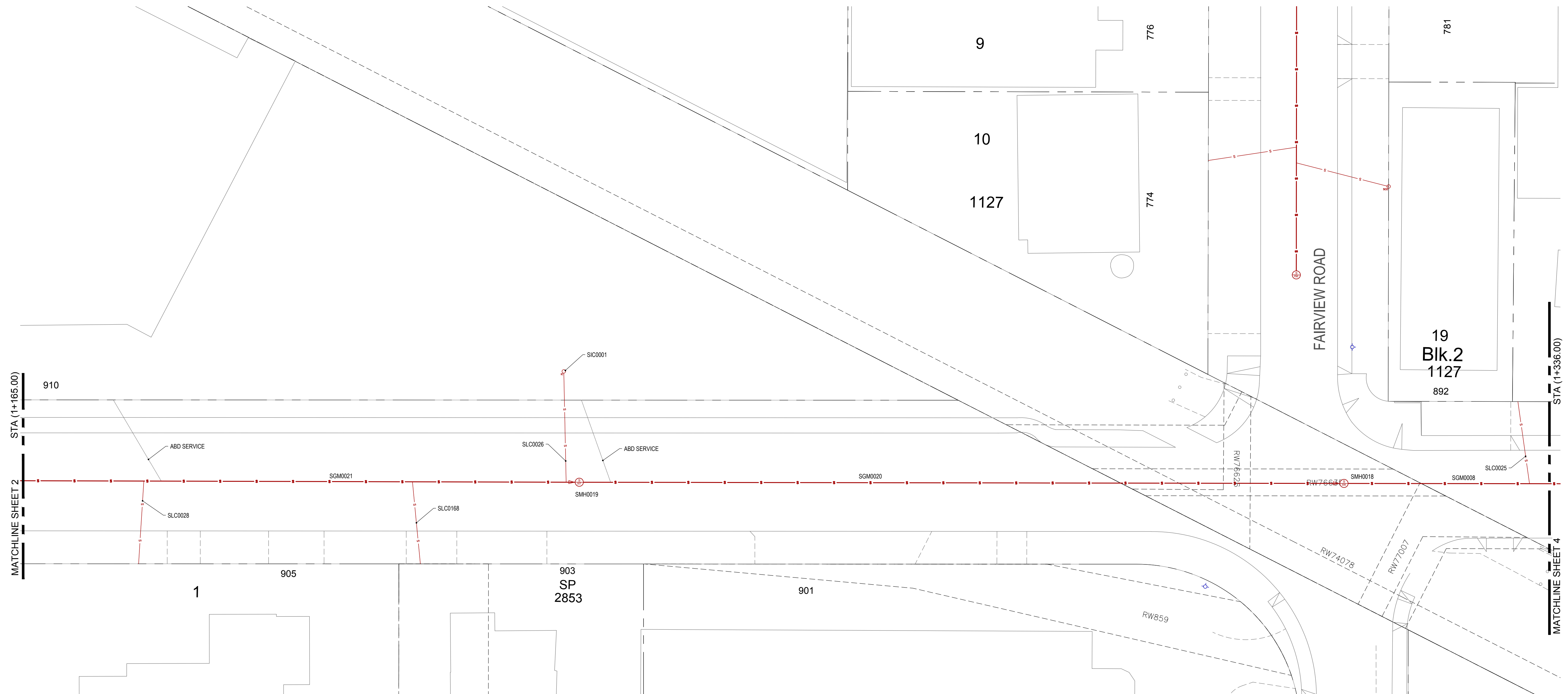
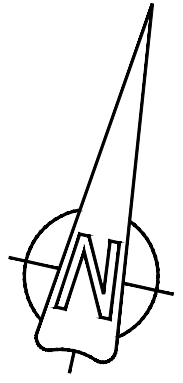

CONFIRM
 UNDERGROUND
 LOCATIONS WITH
 UTILITY COMPANIES

LEGEND - Existing services shown solid	
CABLE —TV—	TEL POLE T
DRAIN —D—	SURVEY MONUMENT ⊕
GAS —GAS—	IRON PIN IP
SEWER —S—	LEAD PLUG LP
WATER —W—	TRAVERSE HUB
ELECTRICAL —E—	P.K. NAIL PK
SIDEWALK S/W	TREE
DRAIN MANHOLE	CATCH BASIN
GAS VALVE	GAS SNIFFER
SEWER MANHOLE	SEWER LAMPHOLE
WATER VALVE	FIRE HYDRANT
ELECTRIC POLE E	TEL POLE T
DRAIN CLEANOUT DCO	DRAIN VENT DV
GAS METER	STREET LIGHT
SEWER CLEANOUT SCO	SEWER VENT SV
WATER METER	SERVICE VALVE

REVISIONS	REVISIONS APPROVED								
	REVISION 1			REVISION 2			REVISION 3		
ISSUED FOR REVIEW	APP.	DATE	SIGN	APP.	DATE	SIGN	APP.	DATE	SIGN

DESIGN APPROVED		
EXCEPTIONS	DATE	SIGN
APPROVED BY	17.02.10	WW
DESIGN ENG.		
ASSIST. ENG.		
MUNICIPAL ENG.		

TOWNSHIP OF ESQUIMALT
 DEVONSHIRE ROAD INVESTIGATIVE WORK
 SEWER IDENTIFIER STA (1+165.00 - 1+336.00)

DESIGN DWG. NO.	ESQ-M101
Sheet #	3

DISCLAIMER:
 LOCATION OF UTILITIES SHOWN ARE APPROXIMATE ONLY AND SHOULD BE CONFIRMED BY FIELD SURVEY AND BY USE OF A PIPE LOCATOR AND MANUAL DIGGING WHERE REQUIRED. EXISTING SERVICE LOCATIONS ARE SHOWN TO INDICATE THE EXISTENCE OF THE SPECIFIED SERVICE ONLY AND ARE NOT NECESSARILY COMPLETE OR SHOWN IN THE CORRECT LOCATION. IT IS THE CONTRACTOR'S RESPONSIBILITY TO LOCATE, VERIFY THE INVERT ELEVATIONS BY HAND EXCAVATION BEFORE CONSTRUCTION OF THE UTILITY CROSSING AND SHALL BE RESPONSIBLE FOR ADEQUATE PROTECTION FROM DAMAGE AT CONTRACTOR'S COST

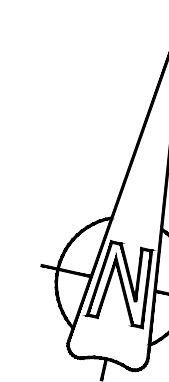

LEGEND:

SMH#### = IDENTIFIER CODE FOR SEWER MANHOLE STRUCTURE
 SLC#### = IDENTIFIER CODE FOR SEWER SERVICE LATERAL CONNECTION
 SGM#### = IDENTIFIER CODE FOR GRAVITY TYPE SEWER MAIN PIPE

MATCHLINE SHEET 3
STA (1+336.00)

MATCHLINE SHEET 5
STA (1+580.00)

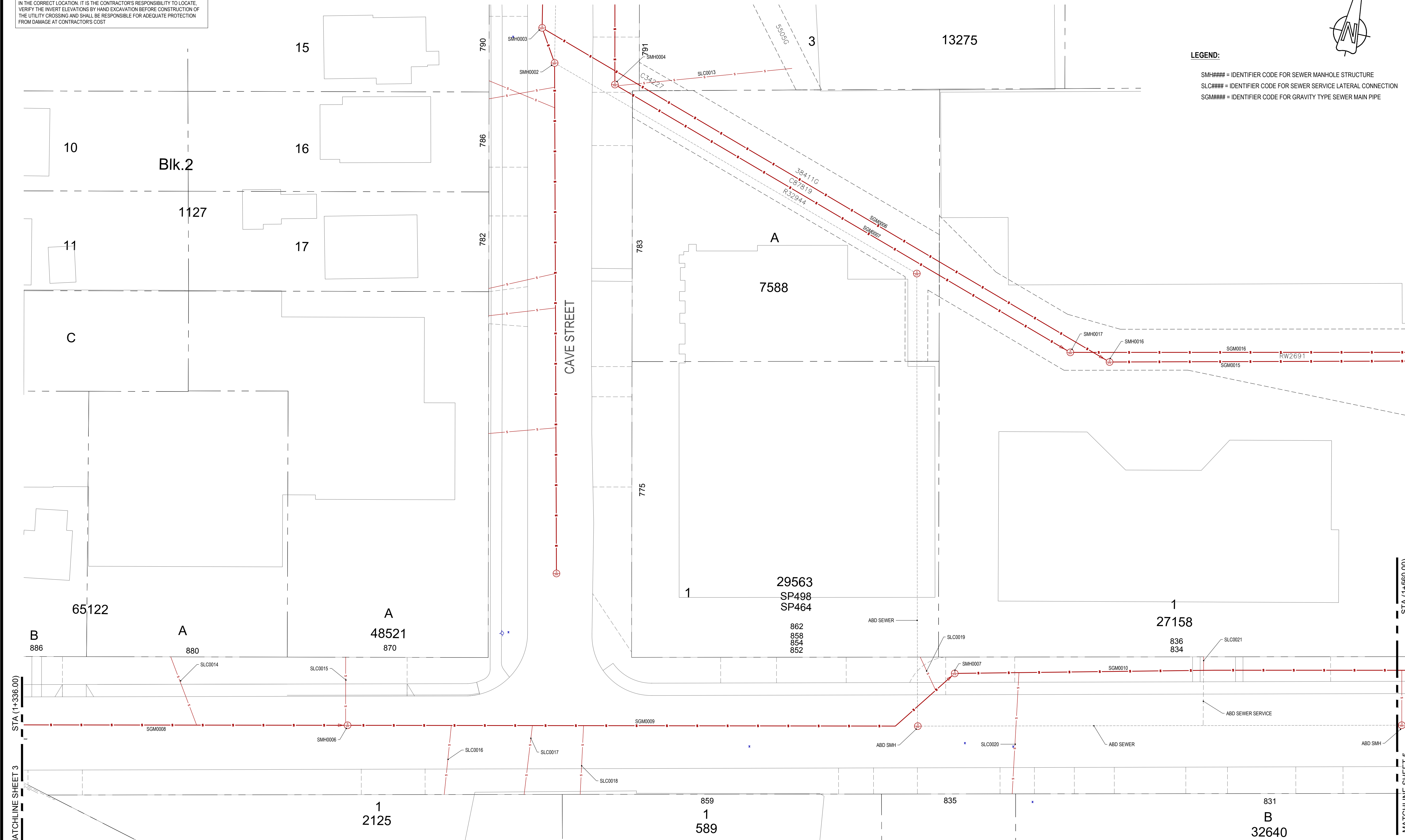

CONFIRM UNDERGROUND LOCATIONS WITH UTILITY COMPANIES

LEGEND - Existing services shown solid	
CABLE —TV—	TEL POLE T
DRAIN —D—	SURVEY MONUMENT ⊕
GAS —GAS—	IRON PIN IP
SEWER —S—	LEAD PLUG LP
WATER —W—	TRAVERSE HUB
ELECTRICAL —E—	P.K. NAIL PK
SIDEWALK S/W	
TREE	
CATCH BASIN	
GAS VALVE	
SEWER MANHOLE	
WATER VALVE	
SEWER LAMPHOLE	
FIRE HYDRANT	
ELECTRIC POLE E	
TEL POLE T	
DRAIN CLEANOUT DCO	
GAS METER	
SEWER CLEANOUT SCO	
WATER METER	
DRAIN VENT DV	
STREET LIGHT	
SEWER VENT SV	
SERVICE VALVE	

REVISIONS		REVISIONS APPROVED						DESIGN APPROVED		
NO.	DESCRIPTION	APP.	DATE	SIGN	APP.	DATE	SIGN	APP.	DATE	SIGN
1	ISSUED FOR REVIEW									

TOWNSHIP OF ESQUIMALT									
DEVONSHIRE ROAD INVESTIGATIVE WORK									
SEWER IDENTIFIER STA (1+336.00 - 1+520.00)									
REVISIONS APPROVED					DESIGN APPROVED				
REVISION 1	REVISION 2	REVISION 3	EXCEPTIONS	DATE	SIGN	DESIGN BY	DATE	SIGN	CONTROL MONUMENTS
				17.02.10	WW				

DESIGN DWG. NO.	ESQ-M102
DESIGN	EFS
DRAWN	EFS
SURVEY	HH
DATE	2017.02.10
Sheet #	4

DISCLAIMER:
 LOCATION OF UTILITIES SHOWN ARE APPROXIMATE ONLY AND SHOULD BE CONFIRMED BY FIELD SURVEY AND BY USE OF A PIPE LOCATOR AND MANUAL DIGGING WHERE REQUIRED. EXISTING SERVICE LOCATIONS ARE SHOWN TO INDICATE THE EXISTENCE OF THE SPECIFIED SERVICE ONLY AND ARE NOT NECESSARILY COMPLETE OR SHOWN IN THE CORRECT LOCATION. IT IS THE CONTRACTOR'S RESPONSIBILITY TO LOCATE, VERIFY THE INVERT ELEVATIONS BY HAND EXCAVATION BEFORE CONSTRUCTION OF THE UTILITY CROSSING AND SHALL BE RESPONSIBLE FOR ADEQUATE PROTECTION FROM DAMAGE AT CONTRACTOR'S COST

LEGEND:
 DMH#### = IDENTIFIER CODE FOR DRAIN MANHOLE STRUCTURE
 DGM#### = IDENTIFIER CODE FOR GRAVITY TYPE DRAIN MAIN PIPE
 DLC#### = IDENTIFIER CODE FOR DRAIN SERVICE LATERAL CONNECTION
 DNC#### = IDENTIFIER CODE FOR TERMINAL END OF GRAVITY DRAIN PIPE WITHOUT MANHOLE/CLEAN-OUT
 CB#### = IDENTIFIER CODE FOR CATCH BASIN
 CBL#### = IDENTIFIER CODE FOR CATCH BASIN LEAD
 DCO#### = IDENTIFIER CODE FOR DRAIN CLEAN-OUT

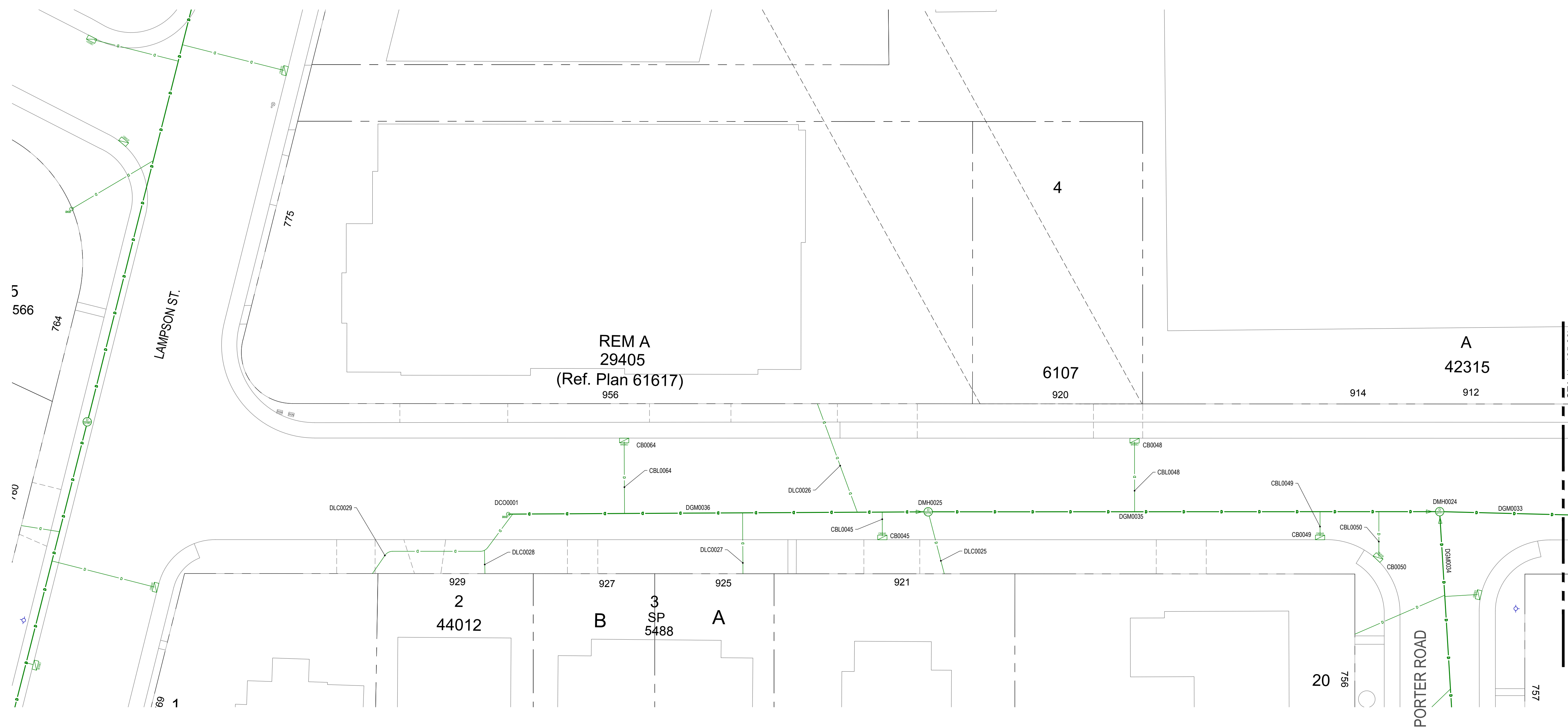
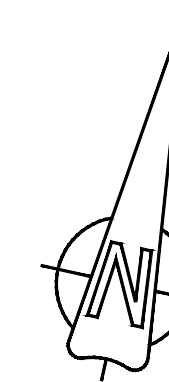

CONFIRM
 UNDERGROUND
 LOCATIONS WITH
 UTILITY COMPANIES

LEGEND - Existing services shown solid	
CABLE —TV—	TEL POLE T
DRAIN —D—	SURVEY MONUMENT ⊕
GAS —GAS—	IRON PIN IP
SEWER —S—	LEAD PLUG LP
WATER —W—	TRAVERSE HUB
ELECTRICAL —E—	P.K. NAIL PK
SIDEWALK S/W	TREE
DRAIN MANHOLE	CATCH BASIN
GAS VALVE	GAS SNIFFER
SEWER MANHOLE	SEWER LAMPHOLE
WATER VALVE	FIRE HYDRANT
ELECTRIC POLE E	TEL POLE T
DRAIN CLEANOUT DCO	DRAIN VENT DV
GAS METER	STREET LIGHT
SEWER CLEANOUT SCO	SEWER VENT SV
WATER METER	SERVICE VALVE

REVISIONS
 ISSUED FOR REVIEW

REVISIONS APPROVED		
REVISION 1	REVISION 2	REVISION 3
APP.	DATE	SIGN

DESIGN APPROVED		
EXCEPTIONS	DATE	SIGN
	17.02.10	WW

TOWNSHIP OF ESQUIMALT
 DEVONSHIRE ROAD INVESTIGATIVE WORK
 DRAIN IDENTIFIER STA (1+033.10 - 1+165.00)

DESIGN DWG. NO.	ESQ-M200
DESIGN EFS	DATE 2017.02.10
DRAWN EFS	SURVEY HH
SCALE: H=1:250	SHEET # 6

DISCLAIMER:
 LOCATION OF UTILITIES SHOWN ARE APPROXIMATE ONLY AND SHOULD BE CONFIRMED BY FIELD SURVEY AND BY USE OF A PIPE LOCATOR AND MANUAL DIGGING WHERE REQUIRED. EXISTING SERVICE LOCATIONS ARE SHOWN TO INDICATE THE EXISTENCE OF THE SPECIFIED SERVICE ONLY AND ARE NOT NECESSARILY COMPLETE OR SHOWN IN THE CORRECT LOCATION. IT IS THE CONTRACTOR'S RESPONSIBILITY TO LOCATE, VERIFY THE INVERT ELEVATIONS BY HAND EXCAVATION BEFORE CONSTRUCTION OF THE UTILITY CROSSING AND SHALL BE RESPONSIBLE FOR ADEQUATE PROTECTION FROM DAMAGE AT CONTRACTOR'S COST

LEGEND:
 DMH#### = IDENTIFIER CODE FOR DRAIN MANHOLE STRUCTURE
 DGM#### = IDENTIFIER CODE FOR GRAVITY TYPE DRAIN MAIN PIPE
 DLC#### = IDENTIFIER CODE FOR DRAIN SERVICE LATERAL CONNECTION
 DNC#### = IDENTIFIER CODE FOR TERMINAL END OF GRAVITY DRAIN PIPE WITHOUT MANHOLE/CLEAN-OUT
 CB#### = IDENTIFIER CODE FOR CATCH BASIN
 CBL#### = IDENTIFIER CODE FOR CATCH BASIN LEAD

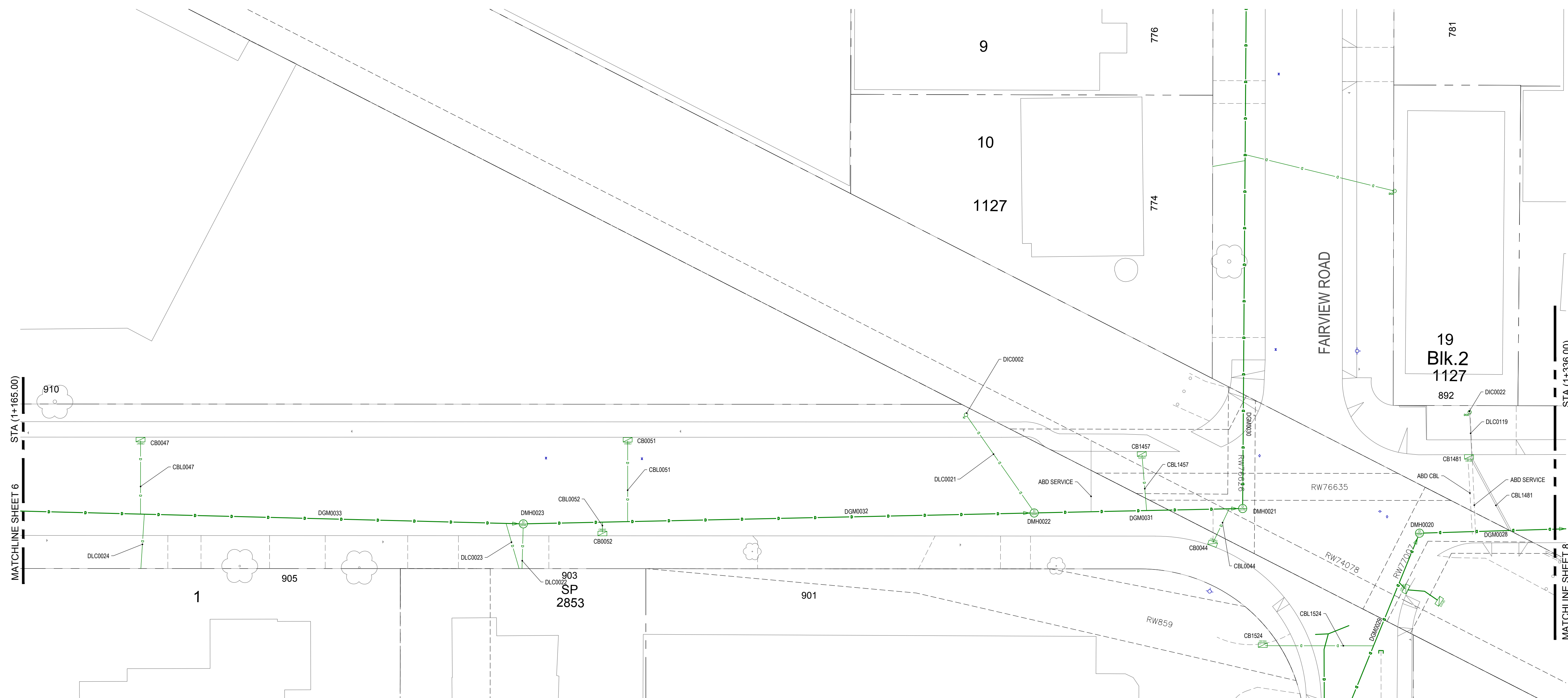
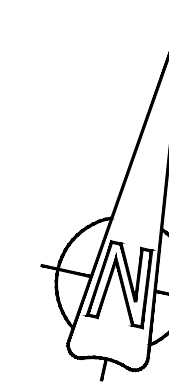

CONFIRM
 UNDERGROUND
 LOCATIONS WITH
 UTILITY COMPANIES

LEGEND - Existing services shown solid					
CABLE —TV—	SIDEWALK S/W	TREE	ELECTRIC POLE E	TEL POLE T	SURVEY MONUMENT
DRAIN —D—	DRAIN MANHOLE	CATCH BASIN	DRAIN CLEANOUT DCO	DRAIN VENT DV	IRON PIN IP
GAS —GAS—	GAS VALVE	GAS SNIFFER	GAS METER	STREET LIGHT	LEAD PLUG LP
SEWER —S—	SEWER MANHOLE	SEWER LAMPHOLE	SEWER CLEANOUT SCO	SEWER VENT SV	TRAVERSE HUB TH
WATER —W—	WATER VALVE	FIRE HYDRANT	WATER METER	SERVICE VALVE	P.K. NAIL PK

REVISIONS	REVISIONS APPROVED			DESIGN APPROVED		
	APP.	DATE	SIGN	APP.	DATE	SIGN
ISSUED FOR REVIEW						

DESIGN APPROVED		TOWNSHIP OF ESQUIMALT	
EXCEPTIONS	DATE	DEVONSHIRE ROAD INVESTIGATIVE WORK	
APPROVED BY	17.02.10	DRAIN IDENTIFIER STA (1+165.00 - 1+336.00)	
DESIGN ENG.		CONTROL MONUMENTS	
ASSIST. ENG.		DESIGN EFS	DRAWN EFS
MUNICIPAL ENG.		SCALE: H=1:250	SURVEY HH
			DATE 2017.02.10

DESIGN DWG. NO.	ESQ-M201
Sheet #	7

LEGEND:

- DMH#### = IDENTIFIER CODE FOR DRAIN MANHOLE STRUCTURE
- DGM#### = IDENTIFIER CODE FOR GRAVITY TYPE DRAIN MAIN PIPE
- DLC#### = IDENTIFIER CODE FOR DRAIN SERVICE LATERAL CONNECTION
- DNC#### = IDENTIFIER CODE FOR TERMINAL END OF GRAVITY DRAIN PIPE WITHOUT MANHOLE/CLEAN-OUT
- CB#### = IDENTIFIER CODE FOR CATCH BASIN
- CBL#### = IDENTIFIER CODE FOR CATCH BASIN LEAD

DISCLAIMER:
 LOCATION OF UTILITIES SHOWN ARE APPROXIMATE ONLY AND SHOULD BE CONFIRMED BY FIELD SURVEY AND BY USE OF A PIPE LOCATOR AND MANUAL DIGGING WHERE REQUIRED. EXISTING SERVICE LOCATIONS ARE SHOWN TO INDICATE THE EXISTENCE OF THE SPECIFIED SERVICE ONLY AND ARE NOT NECESSARILY COMPLETE OR SHOWN IN THE CORRECT LOCATION. IT IS THE CONTRACTOR'S RESPONSIBILITY TO LOCATE, VERIFY THE INVERT ELEVATIONS BY HAND EXCAVATION BEFORE CONSTRUCTION OF THE UTILITY CROSSING AND SHALL BE RESPONSIBLE FOR ADEQUATE PROTECTION FROM DAMAGE AT CONTRACTOR'S COST

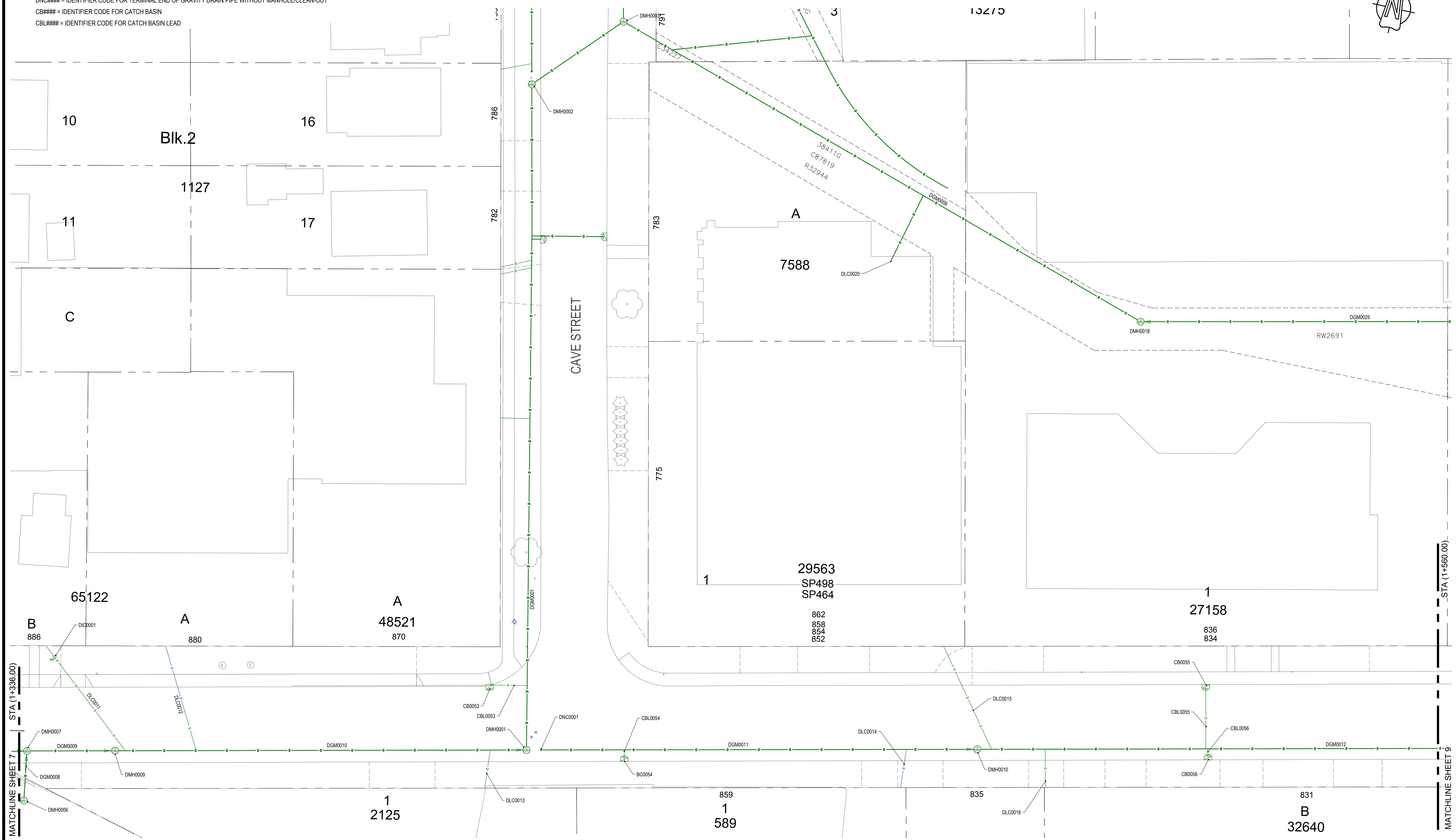
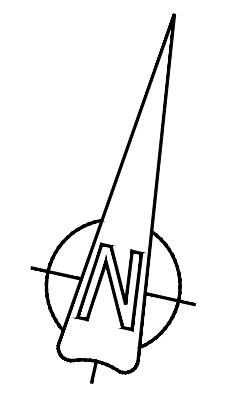

<p>CONFIRM UNDERGROUND LOCATIONS WITH UTILITY COMPANIES</p>	LEGEND - Existing services shown solid															REVISIONS			REVISIONS APPROVED			DESIGN APPROVED			TOWNSHIP OF ESQUIMALT		<p>DESIGN DWG. NO. ESQ-M202</p> <p>Sheet # 8</p>
	CABLE —TV—	SIDEWALK S/W	TREE	ELECTRIC POLE E	TEL POLE T	SURVEY MONUMENT M										DEVONSHIRE ROAD INVESTIGATIVE WORK											
	DRAIN —D—	DRAIN MANHOLE	CATCH BASIN	DRAIN CLEANOUT DCO	DRAIN VENT DV	IRON PIN IP										DRAIN IDENTIFIER STA (1+336.00 - 1+520.00)											
	GAS —GAS—	GAS VALVE	GAS SNIFFER	GAS METER	STREET LIGHT	LEAD PLUG LP										CONTROL MONUMENTS											
SEWER —S—	SEWER MANHOLE	SEWER LAMPHOLE	SEWER CLEANOUT SCO	SEWER VENT SV	TRAVERSE HUB TH										DESIGN EFS DRAWN EFS SURVEY HH												
WATER —W—	WATER VALVE	FIRE HYDRANT	WATER METER	SERVICE VALVE	P.K. NAIL PK										SCALES: H=1:250 DATE 2017.02.10												
ELECTRICAL —E—															MUNICIPAL ENG.												

LEGEND:

- DMH#### = IDENTIFIER CODE FOR DRAIN MANHOLE STRUCTURE
- DGM#### = IDENTIFIER CODE FOR GRAVITY TYPE DRAIN MAIN PIPE
- DLC#### = IDENTIFIER CODE FOR DRAIN SERVICE LATERAL CONNECTION
- DNC#### = IDENTIFIER CODE FOR TERMINAL END OF GRAVITY DRAIN PIPE WITHOUT MANHOLE/CLEAN-OUT
- CB#### = IDENTIFIER CODE FOR CATCH BASIN
- CBL#### = IDENTIFIER CODE FOR CATCH BASIN LEAD

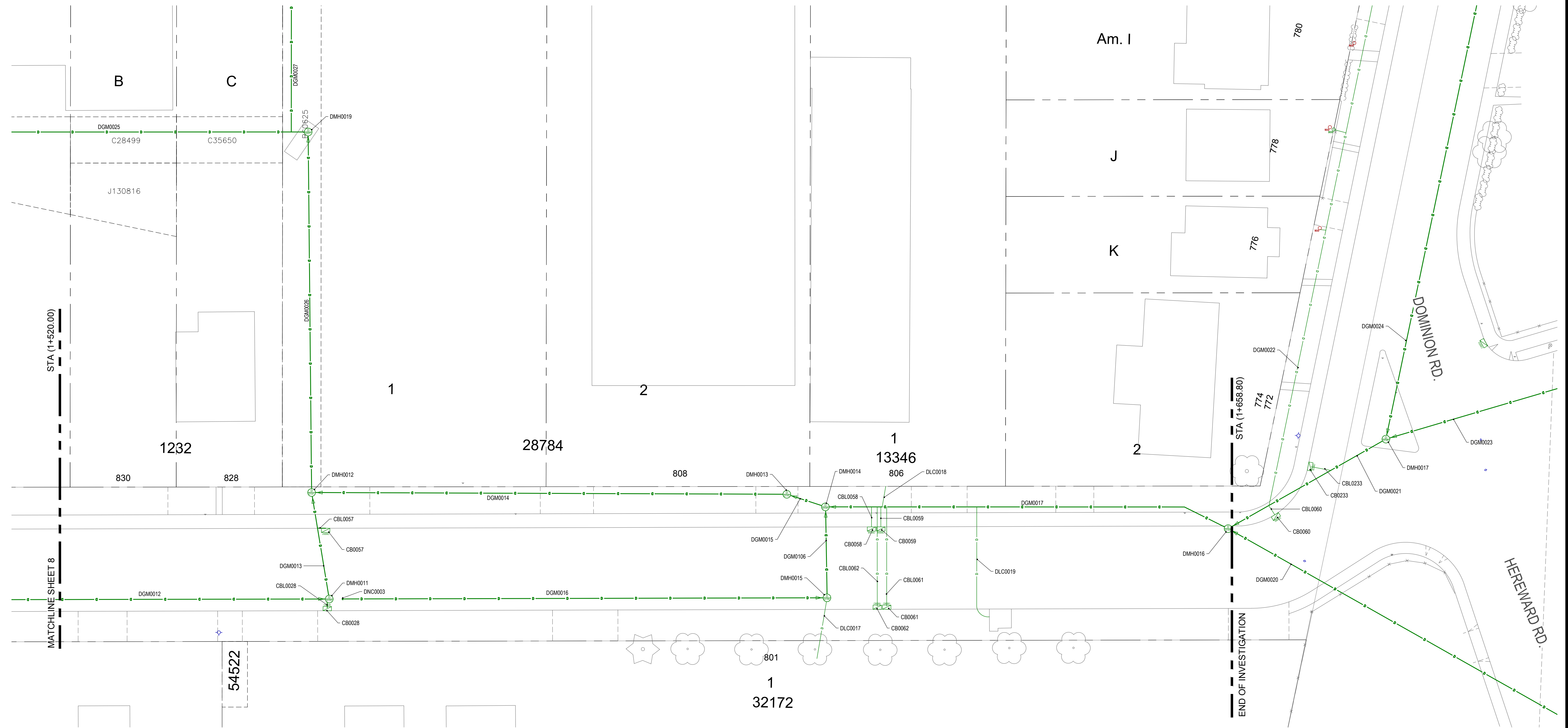
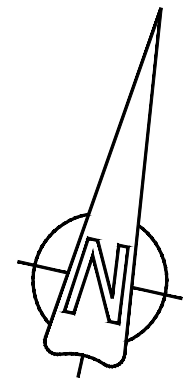

DISCLAIMER:
 LOCATION OF UTILITIES SHOWN ARE APPROXIMATE ONLY AND SHOULD BE CONFIRMED BY FIELD SURVEY AND BY USE OF A PIPE LOCATOR AND MANUAL DIGGING WHERE REQUIRED. EXISTING SERVICE LOCATIONS ARE SHOWN TO INDICATE THE EXISTENCE OF THE SPECIFIED SERVICE ONLY AND ARE NOT NECESSARILY COMPLETE OR SHOWN IN THE CORRECT LOCATION. IT IS THE CONTRACTOR'S RESPONSIBILITY TO LOCATE, VERIFY THE INVERT ELEVATIONS BY HAND EXCAVATION BEFORE CONSTRUCTION OF THE UTILITY CROSSING AND SHALL BE RESPONSIBLE FOR ADEQUATE PROTECTION FROM DAMAGE AT CONTRACTOR'S COST

<p>CONFIRM UNDERGROUND LOCATIONS WITH UTILITY COMPANIES</p>	LEGEND - Existing services shown solid															REVISIONS			REVISIONS APPROVED			DESIGN APPROVED			TOWNSHIP OF ESQUIMALT			<p>DESIGN DWG. NO. ESQ-M203</p> <p>Sheet # 9</p>				
	CABLE —TV—	SIDEWALK S/W	TREE	ELECTRIC POLE E	TEL POLE T	SURVEY MONUMENT				REVISION 1			REVISION 2			REVISION 3			DEVONSHIRE ROAD INVESTIGATIVE WORK													
	DRAIN —D—	DRAIN MANHOLE	CATCH BASIN	DRAIN CLEANOUT DCO	DRAIN VENT DV	IRON PIN IP				APP.	DATE	SIGN	APP.	DATE	SIGN	APP.	DATE	SIGN	EXCEPTIONS	DATE	SIGN	DRAIN IDENTIFIER STA (1+520-1+658.80)										
	GAS —GAS—	GAS VALVE	GAS SNIFFER	GAS METER	STREET LIGHT	LEAD PLUG LP				ISSUED FOR REVIEW									APPROVED BY	17.02.10	WW											
SEWER —S—	SEWER MANHOLE	SEWER LAMPHOLE	SEWER CLEANOUT SCO	SEWER VENT SV	TRAVERSE HUB TH													DESIGN ENG.			CONTROL MONUMENTS											
WATER —W—	WATER VALVE	FIRE HYDRANT	WATER METER	SERVICE VALVE	P.K. NAIL PK													ASSIST. ENG.			DESIGN EFS			DRAWN EFS			SURVEY HH					
ELECTRICAL —E—																		MUNICIPAL ENG.			SCALES:	H=1:250		DATE	2017.02.10							

DISCLAIMER:
 LOCATION OF UTILITIES SHOWN ARE APPROXIMATE ONLY AND SHOULD BE CONFIRMED BY FIELD SURVEY AND BY USE OF A PIPE LOCATOR AND MANUAL DIGGINGS WHERE REQUIRED. EXISTING SERVICE LOCATIONS ARE SHOWN TO INDICATE THE EXISTENCE OF THE SPECIFIED SERVICE ONLY AND ARE NOT NECESSARILY COMPLETE OR SHOWN IN THE CORRECT LOCATION. IT IS THE CONTRACTOR'S RESPONSIBILITY TO LOCATE, VERIFY THE INVERT ELEVATIONS BY HAND EXCAVATION BEFORE CONSTRUCTION OF THE UTILITY CROSSING AND SHALL BE RESPONSIBLE FOR ADEQUATE PROTECTION FROM DAMAGE AT CONTRACTOR'S COST

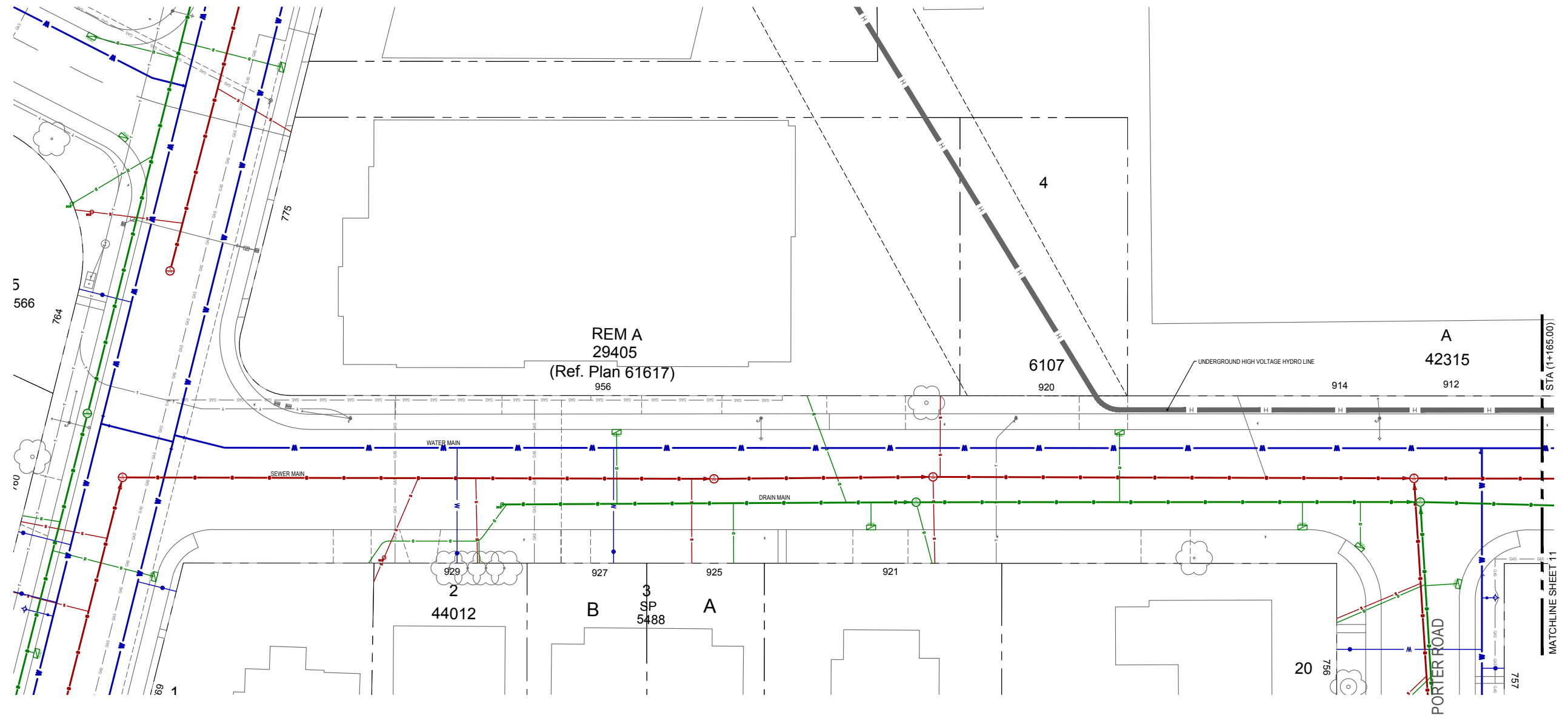
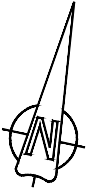

CONFIRM UNDERGROUND LOCATIONS WITH UTILITY COMPANIES

LEGEND - Existing services shown solid					
CABLE —TV—	SIDEWALK S/W	TREE	ELECTRIC POLE E	TEL POLE T	SURVEY MONUMENT
DRAIN —D—	DRAIN MANHOLE	CATCH BASIN	DRAIN CLEANOUT DCO	DRAIN VENT DV	IRON PIN IP
GAS —G—	GAS VALVE	GAS SNIFFER	GAS METER	STREET LIGHT	LEAD PLUG LP
SEWER —S—	SEWER MANHOLE	SEWER LAMPHOLE	SEWER CLEANOUT SCO	SEWER VENT SV	TRAVERSE HUB TH
WATER —W—	WATER VALVE	FIRE HYDRANT	WATER METER	SERVICE VALVE	P.K. NAIL PK

REVISIONS		REVISIONS APPROVED						DESIGN APPROVED		
APP.	DATE	APP.	DATE	SIGN	APP.	DATE	SIGN	EXCEPTIONS	DATE	SIGN
								APPROVED BY	17.02.10	WW
								DESIGN ENG.		
								ASSIST. ENG.		
								MUNICIPAL ENG.		

TOWNSHIP OF ESQUIMALT
 DEVONSHIRE ROAD INVESTIGATIVE WORK
 COMBINED UTILITIES STA (1+033.10 - 1+165.00)
 CONTROL MONUMENTS
 DESIGN EFS DRAWN EFS SURVEY HH
 SCALES: H=1:250 DATE 2017.02.10

DESIGN DWG. NO.	ESQ-M300
Sheet #	10

DISCLAIMER:
 LOCATION OF UTILITIES SHOWN ARE APPROXIMATE ONLY AND SHOULD BE CONFIRMED BY FIELD SURVEY AND BY USE OF A PIPE LOCATOR AND MANUAL DIGGING WHERE REQUIRED. EXISTING SERVICE LOCATIONS ARE SHOWN TO INDICATE THE EXISTENCE OF THE SPECIFIED SERVICE ONLY AND ARE NOT NECESSARILY COMPLETE OR SHOWN IN THE CORRECT LOCATION. IT IS THE CONTRACTOR'S RESPONSIBILITY TO LOCATE, VERIFY THE INVERT ELEVATIONS BY HAND EXCAVATION BEFORE CONSTRUCTION OF THE UTILITY CROSSING AND SHALL BE RESPONSIBLE FOR ADEQUATE PROTECTION FROM DAMAGE AT CONTRACTOR'S COST

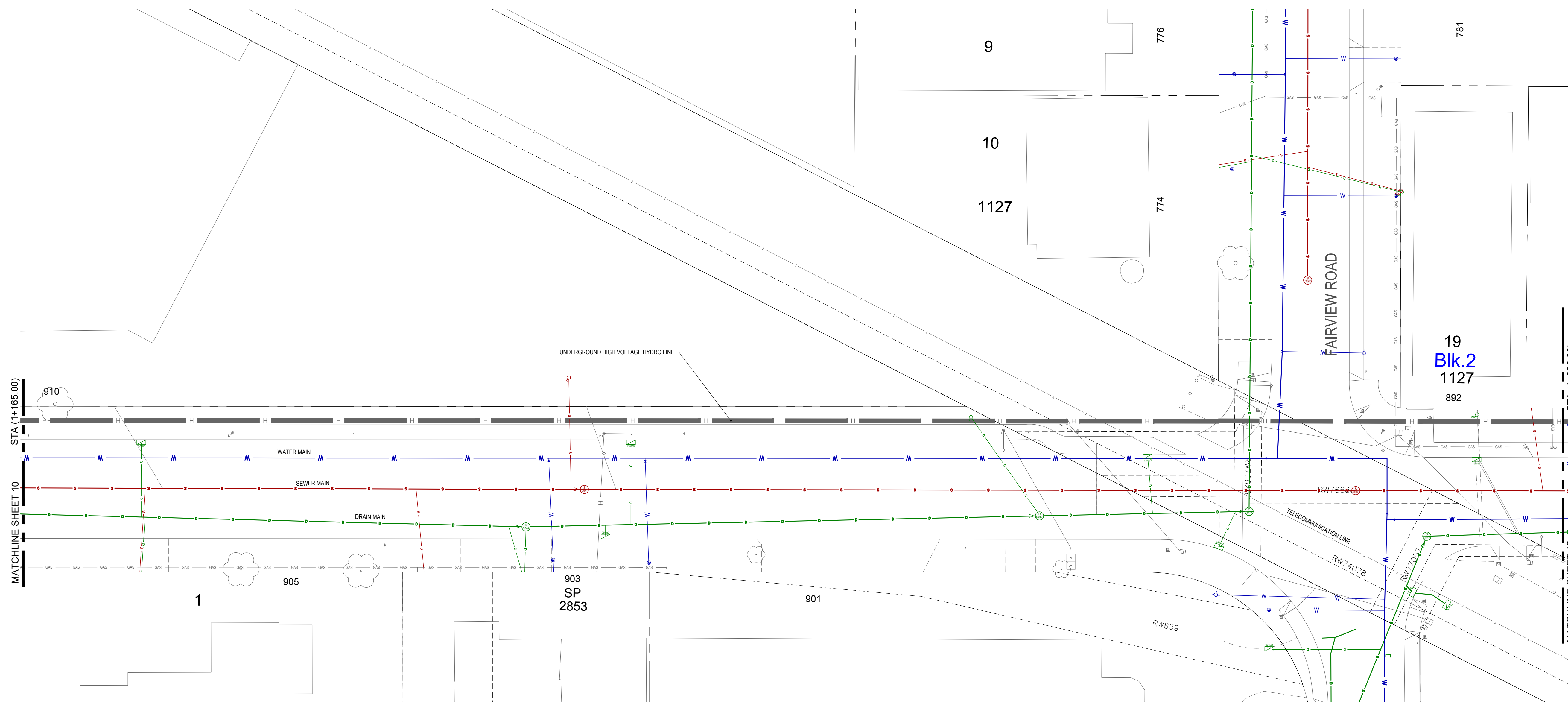
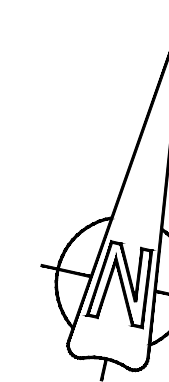

CONFIRM UNDERGROUND LOCATIONS WITH UTILITY COMPANIES

LEGEND - Existing services shown solid	
CABLE —TV—	TEL POLE T
DRAIN —D—	SURVEY MONUMENT ⊕
GAS —GAS—	IRON PIN IP ²
SEWER —S—	LEAD PLUG LP ²
WATER —W—	TRAVERSE HUB
ELECTRICAL —E—	P.K. NAIL PK ²
SIDEWALK S/W	TREE
DRAIN MANHOLE	CATCH BASIN
GAS VALVE	GAS SNIFFER
SEWER MANHOLE	SEWER LAMPHOLE
WATER VALVE	FIRE HYDRANT
ELECTRIC POLE E	TEL POLE T
DRAIN CLEANOUT DCO	DRAIN VENT DV
GAS METER	STREET LIGHT
SEWER CLEANOUT SCO	SEWER VENT SV
WATER METER	SERVICE VALVE

REVISIONS	REVISIONS APPROVED								
	REVISION 1			REVISION 2			REVISION 3		
ISSUED FOR REVIEW	APP.	DATE	SIGN	APP.	DATE	SIGN	APP.	DATE	SIGN

DESIGN APPROVED		
EXCEPTIONS	DATE	SIGN
APPROVED BY	17.02.10	WW
DESIGN ENG.		
ASSIST. ENG.		
MUNICIPAL ENG.		

TOWNSHIP OF ESQUIMALT
DEVONSHIRE ROAD INVESTIGATIVE WORK
COMBINED UTILITIES STA (1+165.00 - 1+336.00)

CONTROL MONUMENTS

DESIGN EFS DRAWN EFS SURVEY HH

SCALES: H=1:250 DATE 2017.02.10

DESIGN DWG. NO.	ESQ-M301
Sheet #	11

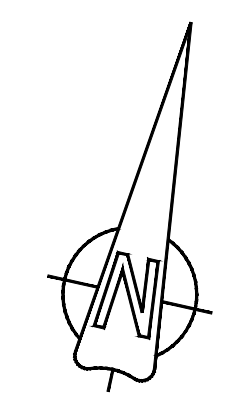

DISCLAIMER:
 LOCATION OF UTILITIES SHOWN ARE APPROXIMATE ONLY AND SHOULD BE CONFIRMED BY FIELD SURVEY AND BY USE OF A PIPE LOCATOR AND MANUAL DIGGING WHERE REQUIRED. EXISTING SERVICE LOCATIONS ARE SHOWN TO INDICATE THE EXISTENCE OF THE SPECIFIED SERVICE ONLY AND ARE NOT NECESSARILY COMPLETE OR SHOWN IN THE CORRECT LOCATION. IT IS THE CONTRACTOR'S RESPONSIBILITY TO LOCATE, VERIFY THE INVERT ELEVATIONS BY HAND EXCAVATION BEFORE CONSTRUCTION OF THE UTILITY CROSSING AND SHALL BE RESPONSIBLE FOR ADEQUATE PROTECTION FROM DAMAGE AT CONTRACTOR'S COST

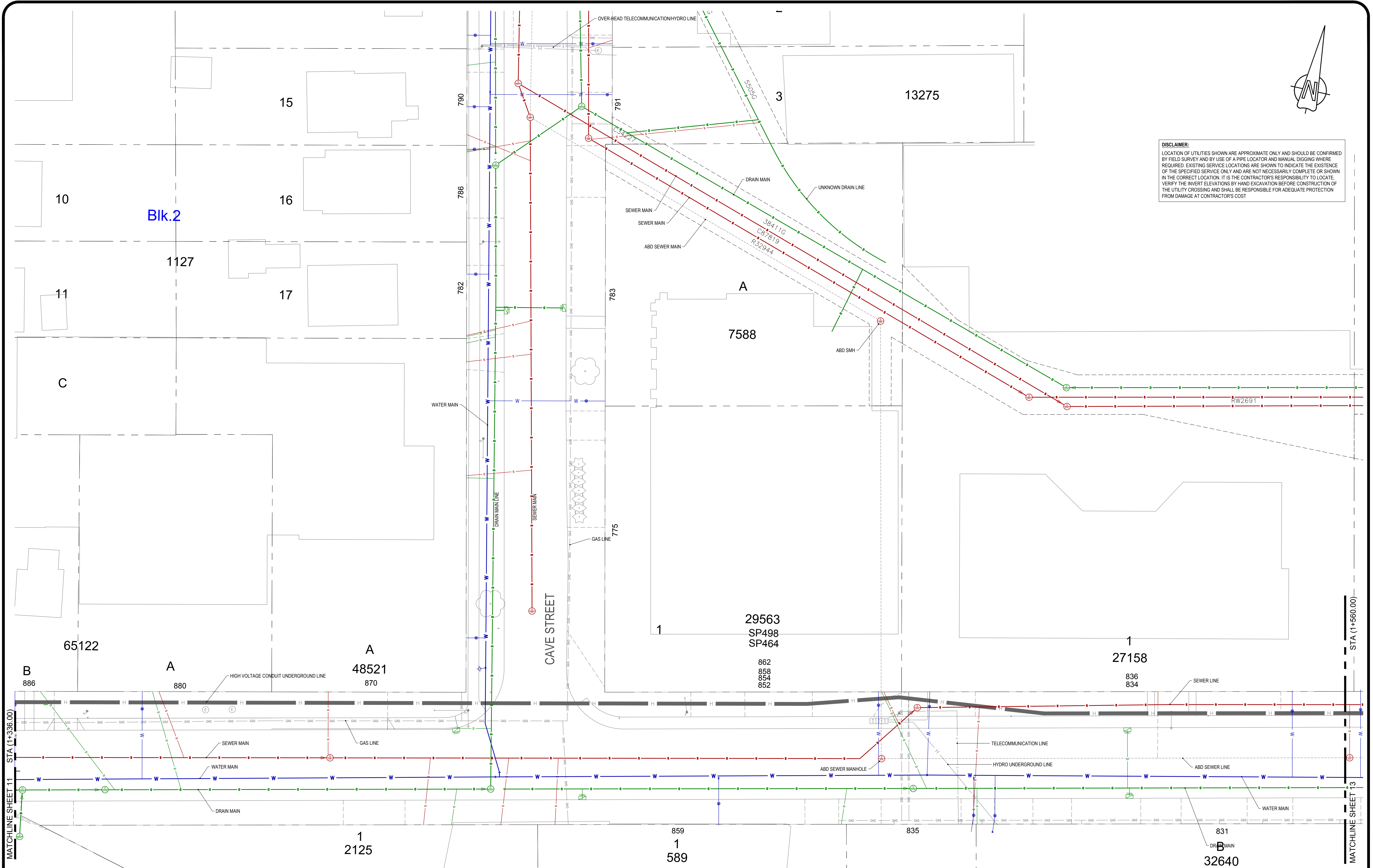

CONFIRM UNDERGROUND LOCATIONS WITH UTILITY COMPANIES	LEGEND - Existing services shown solid										REVISIONS						DESIGN APPROVED			TOWNSHIP OF ESQUIMALT DEVONSHIRE ROAD INVESTIGATIVE WORK COMBINED UTILITIES STA (1+336.00 - 1+520.00)		DESIGN DWG. NO. ESQ-M300
	CABLE —TV—	SIDEWALK S/W	TREE	ELECTRIC POLE	TEL POLE	SURVEY MONUMENT	REVISION 1	REVISION 2	REVISION 3	EXCEPTIONS	DATE	SIGN	DESIGN ENG.	CONTROL MONUMENTS								
	DRAIN —D—	DRAIN MANHOLE	CATCH BASIN	DRAIN CLEANOUT	STREET LIGHT	IRON PIN	APP.	DATE	SIGN	APPROVED BY	17.02.10	WW	ASSIST. ENG.	DESIGN EFS	DRAWN EFS	SURVEY HH						
	GAS —GAS—	GAS VALVE	GAS SNIFFER	GAS METER	SEWER VENT	LEAD PLUG				MUNICIPAL ENG.			MUNICIPAL ENG.	SCALE: H=1:250	DATE 2017.02.10	SHEET #						
SEWER —S—	SEWER MANHOLE	SEWER LAMPHOLE	SEWER CLEANOUT	SEWER VENT	TRAVERSE HUB	ISSUED FOR REVIEW											12					
WATER —W—	WATER VALVE	FIRE HYDRANT	WATER METER	SERVICE VALVE	P.K. NAIL																	
ELECTRICAL —E—																						

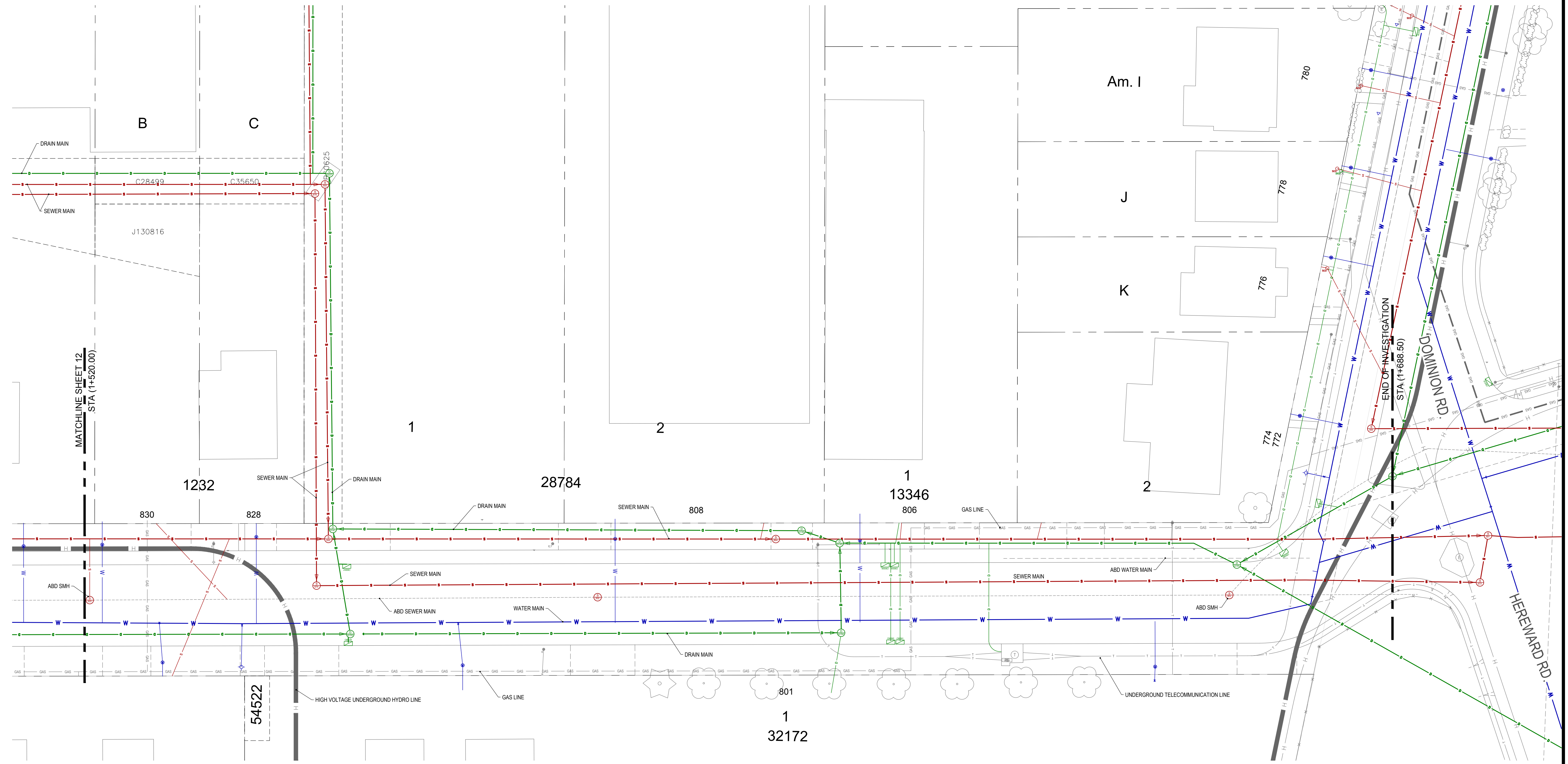
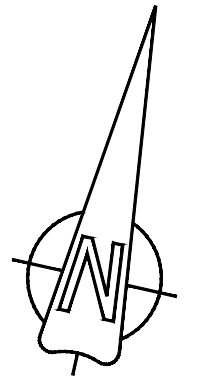

DISCLAIMER:
 LOCATION OF UTILITIES SHOWN ARE APPROXIMATE ONLY AND SHOULD BE CONFIRMED BY FIELD SURVEY AND BY USE OF A PIPE LOCATOR AND MANUAL DIGGINGS WHERE REQUIRED. EXISTING SERVICE LOCATIONS ARE SHOWN TO INDICATE THE EXISTENCE OF THE SPECIFIED SERVICE ONLY AND ARE NOT NECESSARILY COMPLETE OR SHOWN IN THE CORRECT LOCATION. IT IS THE CONTRACTOR'S RESPONSIBILITY TO LOCATE, VERIFY THE INVERT ELEVATIONS BY HAND EXCAVATION BEFORE CONSTRUCTION OF THE UTILITY CROSSING AND SHALL BE RESPONSIBLE FOR ADEQUATE PROTECTION FROM DAMAGE AT CONTRACTOR'S COST

CONFIRM UNDERGROUND LOCATIONS WITH UTILITY COMPANIES	LEGEND - Existing services shown solid										REVISIONS						REVISIONS APPROVED						DESIGN APPROVED			TOWNSHIP OF ESQUIMALT				DESIGN DWG. NO. ESQ-M303 Sheet # 13
	CABLE —TV—	SIDEWALK S/W	TREE	ELECTRIC POLE E	TEL POLE T	SURVEY MONUMENT	REVISION 1	REVISION 2	REVISION 3	EXCEPTIONS	DATE	SIGN	DESIGN ENG.	DESIGN EFS	DRAWN EFS	SURVEY HH	CONTROL MONUMENTS	DESIGN DWG. NO. ESQ-M303 Sheet # 13												
	DRAIN —D—	DRAIN MANHOLE	CATCH BASIN	DRAIN CLEANNOUT DCO	DRAIN VENT DV	IRON PIN IP	APP.	DATE	SIGN	APP.	DATE	SIGN	APP.	DATE	SIGN	DATE	DATE		DATE											
	GAS —GAS—	GAS VALVE	GAS SNIFFER	GAS METER	STREET LIGHT	LEAD PLUG LP																								
SEWER —S—	SEWER MANHOLE	SEWER LAMPHOLE	SEWER CLEANOUT SCO	SEWER VENT SV	TRAVERSE HUB TH	ISSUED FOR REVIEW						APPROVED BY	17.02.10	WW	DESIGN EFS	DRAWN EFS	SURVEY HH	DATE	2017.02.10											
WATER —W—	WATER VALVE	FIRE HYDRANT	WATER METER	SERVICE VALVE SV	P.K. NAIL PK							ASSIST. ENG.																		
ELECTRICAL —E—												MUNICIPAL ENG.																		

