

LOCATION PLAN
SCALE 1:5000

DRAWING INDEX

DRAWING No.	SHEET No.	DRAWING TITLE	REVISION No.
C - 000	1	COVER SHEET, DRAWING INDEX AND LOCATION PLAN	1
C - 100	2	GENERAL NOTES	1
C - 105.1	3	SITE #1 PLAN	1
C - 105.2	4	SITE #2 GRADING & PLAN	1
C - 105.3	5	SITE #3 GRADING & PLAN	1
C - 105.4	6	SITE #4 & 5 PLAN	1
C - 105.5	7	SITE #6 PLAN	1
C - 105.6	8	SITE #7 PLAN	1
C - 801	9	DETAIL PLAN # 1	1
C - 802	10	DETAIL PLAN # 2	1
C - 803	11	DETAIL PLAN # 3	1

GENERAL NOTES:

- 1.0 ALL CONSTRUCTION AND MATERIALS TO BE IN ACCORDANCE WITH MUNICIPAL CONTRACT DOCUMENTS (MMCD) PLATINUM EDITION STANDARD SPECIFICATIONS AND DRAWINGS, EXCEPT AS OTHERWISE NOTED IN THESE DRAWINGS OR THE CONTRACT DOCUMENTS.
- 2.0 CONTRACTOR TO OBTAIN ALL APPLICABLE PERMITS TO UNDERTAKE THE REQUIRED WORKS FROM ALL APPLICABLE AUTHORITIES.
- 3.0 THE CONTRACTOR SHALL NOTIFY IN WRITTEN FORMAT ALL AFFECTED RESIDENCE AND BUSINESSES A MINIMUM 4 DAYS PRIOR TO COMMENCING THE CONSTRUCTION.
- 4.0 TEMPORARY SIGNS WITH CONSTRUCTION DATES AND TIMES ARE TO BE SUPPLIED AND ERECTED IN LOCATIONS PRE-APPROVED BY THE TOWNSHIP OF ESQUIMALT 1 WEEK PRIOR TO CONSTRUCTION. SIGNS TO BE REMOVED FROM THE RIGHT-OF-WAY UPON COMPLETION OF THE CONSTRUCTION.
- 5.0 THE CONTRACTOR SHALL BE RESPONSIBLE FOR THE DISPOSAL OF ALL MILLED AND EXCAVATED MATERIALS TO AN APPROVED DUMP SITE IN ACCORDANCE WITH ALL APPLICABLE REGULATIONS.
- 6.0 CONTRACTOR IS RESPONSIBLE IN MAINTAINING A SINGLE ALTERNATING TRAFFIC FLOW AS PER TENDER.
- 7.0 ALL EQUIPMENT TO BE LEFT ON SITE SHALL BE TEMPORARILY PARKED OFF TRAVELED PORTION OF THE ROAD AS AS DIRECTED BY THE TOWNSHIP.
- 8.0 ELEVATIONS ARE GEODETIC
- 9.0 ALL MEASUREMENTS DIMENSIONS ARE IN METRIC
- 10.0 ALL EXISTING CURBS AND ASPHALT DISTURBED OR SCARRED BY CONSTRUCTION OUTSIDE THE AREA OF RE-CONSTRUCTION ARE TO BE RESTORED TO ITS ORIGINAL CONDITION OR BETTER.
- 11.0 WHERE RECONSTRUCTION OR TYING TO EXISTING CONCRETE CURB OR SIDEWALK, REMOVE AND REPLACE EXISTING CURB OR SIDEWALK TO THE NEAREST EXPANSION JOINT.
- 12.0 THE CONTRACTOR SHALL KEEP THE SITE NEAT AND TIDY AT ALL TIMES TO PROTECT PUBLIC SAFETY.
- 13.0 THE CONTRACTOR SHALL ORGANIZE HIS WORKS TO MINIMIZE INCONVENIENCE TO THE PUBLIC AND INDIVIDUAL PROPERTY OWNERS.
- 14.0 CONTRACTOR TO MAINTAIN SMOOTH TRAFFIC FLOW AT ALL TIMES DURING CONSTRUCTION.
- 15.0 CONTRACTOR TO INSTALL A DESIGNATED SAFE PEDESTRIAN CORRIDOR IN THE EVENT THAT SIDEWALK IS UN-USEABLE TO THE PUBLIC.
- 16.0 ALL MEASUREMENTS AND DIMENSIONS IS IN METRIC.
- 17.0 ALL WORK SHALL BE CONSIDERED NEW UNLESS OTHERWISE NOTED.
- 18.0 THE CONTRACTOR SHALL CHECK AND VERIFY ALL DIMENSIONS, NOTES AND CONDITIONS ON SITE BEFORE ANY CONSTRUCTION WORK SHALL BE STARTED. ALL DISCREPANCIES SHALL BE REPORTED TO THE ENGINEERING DEPARTMENT OF ESQUIMALT. NO WORK OR ORDERING OF MATERIAL MAY BE STARTED UNTIL ALL DIMENSIONED ITEMS HAVE BEEN RESOLVED. NO EXTRA CHARGE OF COMPENSATION WILL BE ALLOWED ON ACCOUNT OF ANY DIFFERENCE BETWEEN ACTUAL DIMENSIONS AND MEASUREMENTS WHICH MAY BE FOUND AS INDICATED ON THE DRAWINGS UNLESS DIRECTED BY THE TOWNSHIP REPRESENTATIVE. THE CONTRACTOR SHALL ASSUME FULL AND UNDIVIDED RESPONSIBILITY FOR THE ACCURACY, FIT, AND STABILITY OF ALL PARTS OF THE WORK.
- 19.0 NO PLANS SHALL BE SCALED; DIMENSIONS SHALL BE USED UNLESS DIRECTED BY THE TOWNSHIP REPRESENTATIVE.
- 20.0 ALL LABOR, MATERIALS AND INSTALLATION MUST COMPLY WITH THE CODES, RULES AND REGULATIONS OF ALL AUTHORITIES HAVING JURISDICTION. ANY DISCREPANCY WHICH EXIST BETWEEN REQUIREMENTS BY THE PLANS, SPECIFICATIONS, SAID CODES, RULES AND REGULATIONS, SHALL BE IMMEDIATELY BROUGHT TO THE ATTENTION OF ESQUIMALT ENGINEERING DEPARTMENT IN WRITING FOR RESOLUTION. IF ANY CHANGE IN PLANS AND / OR SPECIFICATIONS OCCURS AS A RESULT, AN ADJUSTMENT TO THE PROJECT COST IS NEEDED TO REFLECT THE CHANGE THAT COMMENSURATE AND SHALL BE AGREED BY THE CONTRACTOR AND ESQUIMALT.
- 21.0 THE CONTRACTOR SHALL PROVIDE ALL NECESSARY PROTECTION OF EXISTING WORK AND NEWLY ADDED WORK.
- 22.0 THE CONTRACTOR SHALL BE RESPONSIBLE FOR ADEQUATELY BRACING AND PROTECTING ALL WORK DURING CONSTRUCTION AGAINST DAMAGE, BREAKAGE, COLLAPSE, DISTORTION AND MISALIGNMENT ACCORDING TO APPLICABLE CODES AND STANDARDS.
- 23.0 THE CONTRACTOR SHALL REPAIR AND RESTORE TO ITS ORIGINAL CONDITION ALL WORK AND ITEMS DAMAGED AS A RESULT OF THE BUILDING OPERATIONS AND SHALL LEAVE THE WORK COMPLETED TO THE TRUE INTENT OF THE DRAWINGS AND SPECIFICATIONS AND TO THE SATISFACTION OF THE TOWNSHIP REPRESENTATIVE.

GENERAL NOTES CONTINUED:

- 24.0 ALL TRANSITIONS OF NEW WORK TO EXISTING WORK SHALL BE CAREFULLY EXECUTED, EXISTING CONSTRUCTION SHALL BE REPAIRED AS NEEDED AND PATCHED TO MATCH FINISHES OF ADJACENT SURFACES.
- 25.0 CONTRACTOR TO VERIFY OVERHEAD, HORIZONTAL AND VERTICAL LOCATION OF ALL UNDERGROUND UTILITIES PRIOR TO DOING ANY EXCAVATION WORKS.
- 26.0 CONTRACTOR TO USE CERTIFIED TRAFFIC CONTROL PERSONNEL ALWAYS WHEN WORKING IN ANY VEHICULAR TRAVELED AREAS. LOADING AND UNLOADING OF EQUIPMENT AND MATERIAL WITHIN THE SITE ROAD CORRIDOR SHALL BE ASSISTED BY CERTIFIED TRAFFIC CONTROL PERSONNEL. A TRAFFIC MANAGEMENT PLAN SHALL BE SUBMITTED PRIOR TO ANY SITE ACTIVITY TO THE TOWNSHIP. ANY CHANGE IN TRAFFIC MANAGEMENT PLAN BY THE CONTRACTOR SHALL BE DISCUSS 4 DAYS BEFORE IMPLEMENTATION.
- 27.0 WHEN CROSSING GAS LINES, EXTRA CAUTION SHALL BE OBSERVE IF DIGGING WITHIN 0.5m OF ITS HORIZONTAL AND VERTICAL POSITION PROVIDED BY FORTIS BC. MANUAL HAND EXCAVATION IS RECOMMENDED. ANY BREAKAGE AND DAMAGES DURING CONSTRUCTION SHALL BE REPORTED TO FORTIS BC IMMEDIATELY. IN THE EVENT OF GAS LEAK, EVACUATE THE WORK SITE, SEAL AND CORDON THE AREA AND CALL 911.
- 28.0 CONTRACTOR TO NOTIFY BC TRANSIT 1 WEEK PRIOR TO ROAD CONSTRUCTION. ANY IMPACTED BUS PICKUP/DROP-OFF TO BE MARKED IN THE PLAN AND SUBMITTED FOR BUS RE-ROUTING AND TEMPORARY BUS STOP RELOCATION.
- 29.0 SIDEWALK CLOSURES SHALL BE DONE TO THE NEAREST PEDESTRIAN CROSSWALK. SIDEWALK SIGNS SHOULD BE MARK AND LIGHTED AT NIGHT TIME FOR VISIBILITY.

CONCRETE WORKS:

- 1.0 TOP OF CONCRETE TO MATCH RIM OF EXISTING UTILITY COVERS OR HOUSING NOTIFY TOWNSHIP'S ENGINEERING DEPARTMENT FOR OBVIOUS CHANGE IN GRADE OR CROSS SLOPES.
- 2.0 THE POINT FOR NEW TO EXISTING CONCRETE SIDEWALK SHALL BE SAW-CUT.
- 3.0 COLD JOINT TO BE 1.5m SPACING.
- 4.0 CONTRACTOR TO USE A VIBRATORY SCREED OR EQUAL FOR CONCRETE SIDEWALK, DRIVEWAYS, CROSSINGS, RAMPS, CURB AND GUTTERS. VIBRATORS SHALL NOT BE APPLIED MORE THAN 3 SECONDS IN THE SAME LOCATION.
- 5.0 EXPANSION JOINTS FOR SIDEWALK SHALL BE INSTALLED EVERY 3 PANELS PARTITION TO A MAXIMUM OF 9.0m SPACING. WHILE EXPANSION JOINTS FOR CURB AND GUTTER TO BE EVERY 9.0m. EXPANSION JOINT MATERIALS TO BE OF MMCD SPECIFICATIONS.
- 6.0 CONCRETE DELIVERY ON SITE SHALL BE COMPLETELY POURED NO LATER THAN 90 MINUTES FROM THE MOMENT WATER WAS INTRODUCED TO MIX THE AGGREGATES AND THE CEMENT IN THE BATCHING PLANT FOR STANDARD MIX UNLESS A SPECIAL ADITIVES WAS INTRODUCED AS A REQUIREMENTS. CONTRACTOR TO SHOW TO THE INSPECTOR THE TIME THE TRUCK WAS DISPATCH IN THE PLANT.
- 7.0 NO CONCRETE WORKS SHALL BE ALLOWED IF THE SITE CONDITION'S TEMPERATURE IS BELOW 5°C OR ABOVE 32°C. CONCRETE WORKS CONSTRUCTED AT WARMTH TEMPERATURE SHALL BE DAILY SPRAYED WITH WATER 5 TIMES BETWEEN 10 AM -3PM WHILE CONCRETE WORKS COMPLETED AT 5°C AND EXPECTED TO DROP TO FREEZING LEVEL. REQUIRES A THERMO BLANKETS/TARP FOR AT LEAST 5 DAYS.
- 8.0 CONCRETE WORKS DURING WET DAYS WILL BE ALLOWED IF SIDEWALK OR DRIVEWAY BASE LINE AND GRADE AND FORM WORKS HAS BEEN INSPECTED AND APPROVED BY THE TOWNSHIP'S REPRESENTATIVE. CONTRACTOR TO PROVIDE A PLASTIC COVER TARP ADEQUATE TO COVER THE CONCRETE AREA AFTER CONCRETE WORKS. LEAVE PLASTIC COVER FOR AT LEAST 24 HOURS.
- 9.0 NEW CONCRETE WORKS AT SIDEWALK OR WALKWAY AREAS SHALL BE CLOSED FOR 3 DAYS WHILE CURB AND GUTTER, DRIVEWAYS AND CROSSINGS SHALL BE OPEN ONLY AFTER 2 WEEKS MINIMUM OF CLOSURES.

PAINTLINE WORKS:

- 1.0 ALL EXISTING LINE PAINTING REMOVED SHALL BE RESTORED AS SHOWN.
- 2.0 ALL LINE PAINTING AS PER MINISTRY OF TRANSPORTATION STANDARDS OR TOWNSHIP OF ESQUIMALT.
- 3.0 ZEBRA CROSSWALKS TO BE 3.0m WIDE AND 600mm THICK TOWNSHIP OF ESQUIMALT'S APPROVED WHITE ALKYD PAINTLINE.
- 4.0 DOUBLE CENTER PAINTLINE TO BE 100mm THICK ALKYD YELLOW PAINT LINE PER TOWNSHIP OF ESQUIMALT.
- 5.0 EXISTING PAINTLINE TO BE REMOVED SHALL BE RUBBED OR GRIND TOTALLY.
- 6.0 ALLOW WET PAINT WORKS TO DRY FOR ABOUT 4 HOURS BEFORE OPENING TO TRAFFIC.
- 7.0 ALL EXISTING CURB PAINTING DAMAGED SHALL BE RESTORED.

EROSION AND SEDIMENT CONTROL NOTES:

- 1.0 PHASE CLEARING AND GRADING TO THE MAXIMUM EXTENT PRACTICAL TO PREVENT EXPOSED INACTIVE AREAS FROM BECOMING A SOURCE OF EROSION.
- 2.0 INSTALL SILT FENCE AT THE DOWNSTREAM AREA PRIOR TO ANY WORK TO THE SATISFACTION OF THE TOWNSHIP'S REPRESENTATIVE. SILT FENCE TO BE REMOVED ONLY AFTER COMPLETION OF THE PROJECT OR ALL DISTURBED GROUND COVER HAVE GROWN/RECOVERED.
- 3.0 CONTRACTOR TO PROVIDE A MAINTENANCE LOG REPORT TO THE TOWNSHIP AFTER A MAJOR RAINFALL EVENT OR 4 DAY OF MINOR RAINFALL EVENTS. CONTRACTOR IS EXPECTED TO CLEAN OR REPLACE ANY SEDIMENT CONTROL MEASURES DAMAGED DURING AN EVENT DESCRIBED ABOVE.
- 4.0 ANY STRIPPED AREAS NOT SUBJECT FOR CONSTRUCTION SHALL BE COVERED BY POLYPROPYLENE SINGLE NET STRAW EROSION BLANKET.
- 5.0 ALL EXCAVATED MATERIAL PILED ONSITE SHALL STABILIZED AND BE COVERED BY POLYETHYLENE PLASTIC SHEETS AND SURROUNDED BY A SILT FENCE AT TOE IF THE PILE AT THE END OF THE DAY ESPECIALLY ON WET WEATHER.
- 6.0 CONSTRUCTION ACTIVITIES MUST AVOID OR MINIMIZE EXCAVATION AND CREATION OF BARE GROUNDS DURING WET WEATHER.
- 7.0 USE WATER, SOIL-BINDING AGENT OR OTHER DUST CONTROL TECHNIQUE AS NEEDED TO AVOID WIND-BLOWN SOIL.
- 8.0 INTENTIONAL WASHING OF SEDIMENT INTO STORM SEWERS OR DRAINAGE WAYS MUST NOT OCCUR AT ALL TIMES.
- 9.0 ALL AFFECTED EXISTING CATCH BASIN DOWNSTREAM SHALL BE PROTECTED AT ALL TIMES DURING CONSTRUCTION OPERATION BY FILTREXX SILT50XX OR EQUAL.

ELECTRICAL WORKS:

- 1.0 THE CONTRACTOR SHALL BE RESPONSIBLE FOR OBTAINING ALL REQUIRED ELECTRICAL PERMITS, ARRANGING FOR ALL ELECTRICAL INSPECTIONS COVERING HIS WORK AND PAYING ALL FEES FOR SUCH PERMITS.
- 2.0 EQUIPMENT, INSTALLATION, WIRING METHODS, AND MATERIALS USED SHALL BE IN ACCORDANCE WITH THE LATEST EDITION, INCLUDING AMENDMENTS, OF THE RULES AND REGULATIONS FOR THE INSTALLATION AND MAINTENANCE OF ELECTRICAL EQUIPMENT AS ISSUED BY THE TOWNSHIP OF ESQUIMALT AND THE MMCD (2009 PLATINUM EDITION). WORK SHALL ALSO BE IN ACCORDANCE WITH ALL APPLICABLE MUNICIPAL CODES AND REGULATIONS, PROVINCIAL STATUTES IN EFFECT AT THE SITE, AND THE FIRE MARSHALL AND WORKMENS COMPENSATION ACTS, HEREINAFTER CALLED THE RULES AND REGULATIONS, MAINTAIN ALL CLEARANCES FROM HYDRO POLES AS REQUIRED BY THE CANADIAN ELECTRICAL CODE.
- 3.0 WHEREVER THE DRAWINGS OR SPECIFICATIONS CALL FOR MATERIAL, WORKMANSHIP, ARRANGEMENT OR CONSTRUCTION OF A SUPERIOR QUALITY THAN IS REQUIRED BY THE RULES AND REGULATIONS, THE DRAWINGS AND SPECIFICATIONS SHALL PREVAIL. OTHERWISE, SHOULD THERE BE A CONFLICT BETWEEN THE RULES AND REGULATIONS AND THE DRAWINGS AND SPECIFICATIONS, THE RULES AND REGULATIONS SHALL PREVAIL.
- 4.0 THE CONTRACTOR SHALL OBTAIN, AND PAY FOR ALL PERMITS, AND ARRANGE FOR ALL ELECTRICAL INSPECTIONS COVERING HIS WORK, AND PAY ALL OTHER FEES AND CHARGES, AND MAKE ALL DEPOSITS THAT ARE IN ANY WAY CONNECTED WITH THE INSTALLATION OF THE SYSTEMS SPECIFIED AS SHOWN ON THE DRAWINGS. HE SHALL GIVE ALL NECESSARY NOTICES TO AUTHORITIES HAVING JURISDICTION, AND SHALL BE RESPONSIBLE FOR KEEPING ALL APPLICABLE PUBLIC ORDINANCES.
- 5.0 SHOP DRAWINGS FOR THE THE APPROVED SOLAR PEDESTRIAN CONTROLLED LIGHT SYSTEM (GARMANAH SC 315) SHALL NOT BE ALTERED OR MODIFIED FOR EASE OF INSTALLATION UNLESS GIVEN PERMISSION FROM THE TOWNSHIP.
- 6.0 ALL SUPPLIED MATERIALS CALLED FOR BY THE DRAWING SHALL BE MMCD APPROVE UNLESS CLEARLY SPELLED OUT IN THE CONTRACT DOCUMENTS OR AS DIRECTED BY THE TOWNSHIP.
- 7.0 ALL ELECTRICAL WORK TO BE PERFORMED BY A REGISTERED ELECTRICIAN AND INSPECTION CONTRACTOR UNDER PROVISIONS OF BRITISH COLUMBIA ELECTRICAL SAFETY ACT.
- 8.0 ELECTRICAL WORK TO CONFORM TO THE CURRENT EDITION OF CANADIAN ELECTRICAL CODE AND ANY BULLETINS PUBLISHED BY ELECTRICAL SAFETY BRANCH MINISTRY OF MUNICIPAL AFFAIRS.
- 9.0 WORK TO CONFORM TO ALL APPLICABLE REGULATIONS OF WORKERS' COMPENSATION BOARD (WORKSAFE BC). CONFIRM COMPLIANCE WITH THE FOLLOWING:
 1. WORKSAFE BC FORM 30M33 TO BE COMPLETED PRIOR TO WORKING IN VICINITY OF OVERHEAD POWER LINES.
 2. NOTICE OF CONSTRUCTION PROJECTS, WCB INDUSTRIAL HEALTH AND SAFETY REGULATIONS, SECTION 34.16(3).
- 10.0 ALL CONCRETE BASES AND JUNCTION BOX SYMBOLS ARE NOT TO SCALE.

DRAIN AND SEWER WORKS:

- 1.0 ALL MATERIALS TO MMCD STANDARDS AND SPECIFICATIONS
- 2.0 ALL TRENCHES BELOW 1.2m SHALL BE SHORED PROTECTED
- 3.0 ALL IMPORTED BACKFILL MATERIALS FROM BEDDING TO ROAD BASE SHALL BE MMCD STANDARD CRUSH GRAVEL TYPE 1 STANDARD GRADATION FOR PIPE ZONE WHILE 19mm MINUS CRUSHED GRAVEL FOR GRANULAR BASE.
- 4.0 COMPACTION AT ROAD AREA TO BE 98% MPD WHILE 95 % MPD AT BOULEVARD AND SIDEWALK AREAS.
- 5.0 ALL PVC PIPES TO BE USED SHALL BE SDR 35 DRAIN PVC OR EQUAL.
- 6.0 ALL ACTIVE SERVICE CONNECTIONS AFFECTED SHALL BE RECONNECTED TO NEW DRAIN LINE INSTALLED. ALL UNKNOWN DRAIN SERVICE NOT MARKED IN THE DRAWING PLAN ISSUED SHALL BE FLAG AND REPORTED TO THE TOWNSHIP'S ENGINEERING DEPARTMENT FOR EITHER BE RE-CONNECTED OF BE ABANDONED.
- 7.0 REPORT ALL AS-BUILT DATA TO THE ENGINEERING AFTER THE CONCLUSION OF THE PROJECT.

ROAD WORKS:

- 1.0 DEPTH OF FULL PAVEMENT MILL IS ±100mm FOR ARTERIAL AND MAJOR COLLECTOR ROADS WHILE ±70mm FOR RESIDENTIAL ROADS. TOP PAVEMENT MILL IS 50mm MINIMUM OR AS DIRECTED BY THE TOWNSHIP.
- 2.0 EXISTING OR NEWLY INSTALLED CATCH BASIN, SANITARY / STORM MANHOLES TO BE PROTECTED AT ALL TIMES FROM MILLED AND EXCAVATED MATERIALS DURING THE OPERATION.
- 3.0 ALL CUT AREAS AT EXISTING PAVEMENT EXPOSED FOR ASPHALT OVERLAY SHALL BE APPLIED BY TACK COAT ADEQUATELY.
- 4.0 DURING CONSTRUCTION, THE CONTRACTOR SHALL PROVIDE A TEMPORARY ACCESS TO COMMERCIAL BUSINESS YARD. INSTALL A RAMP ON NEWLY CONSTRUCTED SIDEWALK, CURB AND GUTTER ENOUGH DAYS FOR CONCRETE CURING MIN OF 3 WEEKS.

<p>CONFIRM UNDERGROUND LOCATIONS WITH UTILITY COMPANIES</p>	<p>LEGEND - Existing services shown solid</p>										<p>REVISIONS</p>				<p>REVISIONS APPROVED</p>				<p>DESIGN APPROVED</p>		<p>TOWNSHIP OF ESQUIMALT</p>		<p>PROJECT NO.</p>	<p>E060</p>
	<p>DRAIN --- D --- SIDEWALK S/W TREE ELECTRIC POLE TEL POLE SURVEY MONUMENT LAWN BASIN UNDERGROUND - UG -</p>										<p>ISSUED FOR REVIEW</p>				<p>APP. DATE SIGN APP. DATE SIGN APP. DATE SIGN</p>				<p>EXCEPTIONS DATE SIGN</p>		<p>VARIOUS CAPITAL PROJECTS 2018</p>		<p>DESIGN NO.</p>	<p>C - 100</p>
	<p>GAS --- G --- CATCH BASIN DRAIN CLEANOUT GAS SNIFFER GAS METER STREET LIGHT TEL TEL MANHOLE</p>										<p>WW 18.03.15 JM</p>				<p>DESIGN ENG. DATE SIGN</p>				<p>GENERAL NOTES</p>		<p>DESIGN</p>	<p>C - 100</p>		
	<p>SEWER --- S --- GAS VALVE SEWER MANHOLE HYDRO MANHOLE SEWER CLEANOUT DRAIN/SEWER INSP. CHAMBER TEL MANHOLE</p>										<p>WW 18.03.30 JM</p>				<p>ASSIST. ENG. DATE SIGN</p>				<p>CONTROL MONUMENTS</p>		<p>SHEET #</p>	<p>2</p>		
<p>WATER --- W --- SEWER MANHOLE HYDRO MANHOLE SEWER CLEANOUT DRAIN/SEWER INSP. CHAMBER TEL MANHOLE</p>										<p>WW 18.03.30 JM</p>				<p>MUNICIPAL ENG. DATE SIGN</p>				<p>DESIGN EFS DRAWN EFS SURVEY</p>		<p>SCALE: 1:100</p>	<p>DATE</p>	<p>DATE</p>	<p>DATE</p>	
<p>ELECTRICAL --- E --- WATER VALVE FIRE HYDRANT WATER METER UTILITY CAP DEPTH LINE</p>										<p>WW 18.03.30 JM</p>				<p>SCALE: 1:100</p>				<p>DATE</p>		<p>DATE</p>	<p>DATE</p>			

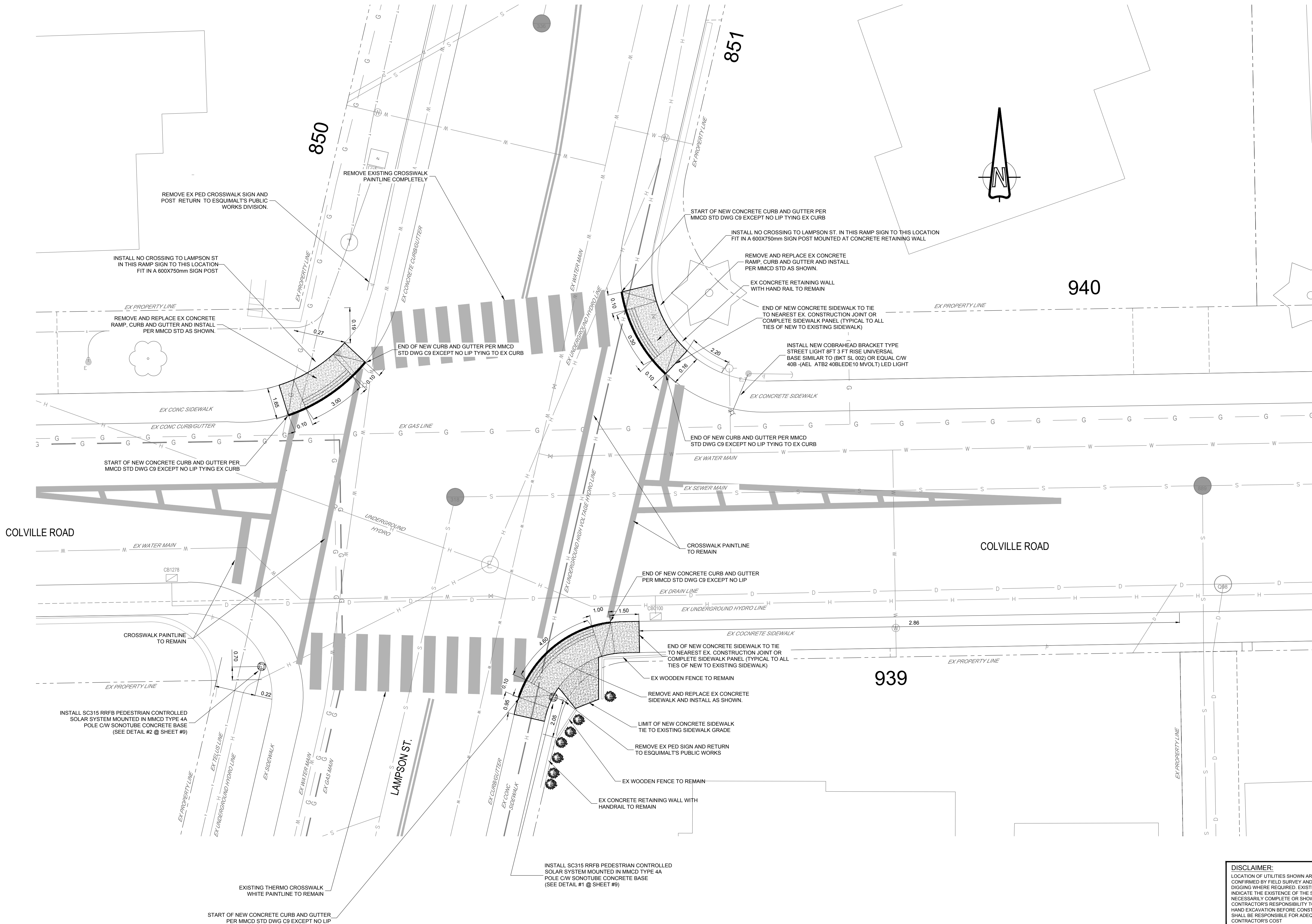

DISCLAIMER:
 LOCATION OF UTILITIES SHOWN ARE APPROXIMATE ONLY AND SHOULD BE CONFIRMED BY FIELD SURVEY AND BY USE OF A PIPE LOCATOR AND MANUAL DIGGINGS WHERE REQUIRED. EXISTING SERVICE LOCATIONS ARE SHOWN TO INDICATE THE EXISTENCE OF THE SPECIFIED SERVICE ONLY AND ARE NOT NECESSARILY COMPLETE OR SHOWN IN THE CORRECT LOCATION. IT IS THE CONTRACTOR'S RESPONSIBILITY TO LOCATE, VERIFY THE INVERT ELEVATIONS BY HAND EXCAVATION BEFORE CONSTRUCTION OF THE UTILITY CROSSING AND SHALL BE RESPONSIBLE FOR ADEQUATE PROTECTION FROM DAMAGE AT CONTRACTOR'S COST

CONFIRM
 UNDERGROUND
 LOCATIONS WITH
 UTILITY COMPANIES

LEGEND - Existing services shown solid

CABLE -	SEWER -	SIDEWALK -	S/W TREE -	ELECTRIC POLE -	TEL POLE -	SURVEY MONUMENT -
DRAIN -	GAS -	DRAIN MANHOLE -	CATCH BASIN -	DRAIN CLEANOUT -	LAWN BASIN -	UNDERGROUND - UC -
SEWER -	WATER -	GAS VALVE -	GAS SNIFFER -	GAS METER -	STREET LIGHT -	TEL -
WATER -	ELECTRICAL -	SEWER MANHOLE -	HYDRO MANHOLE -	SEWER CLEANOUT -	CHAMBER -	TEL MANHOLE -
ELECTRICAL -		WATER VALVE -	FIRE HYDRANT -	WATER METER -	UTILITY CAP -	DITCH LINE -

REVISIONS

REVISIONS		REVISIONS APPROVED	
ISSUED FOR REVIEW	APP. DATE SIGN	REVISION 2	APP. DATE SIGN
	WW 18.03.30 JM		

DESIGN APPROVED

DESIGN APPROVED	DATE SIGN
APPROVED BY	18.03.30 WW
DESIGN ENG.	
ASSIST. ENG.	
MUNICIPAL ENG.	18.03.30 JM

TOWNSHIP OF ESQUIMALT
 VARIOUS CAPITAL PROJECTS 2018

SITE #1 PLAN

CONTROL MONUMENTS

DESIGN	EFS	DRAWN	EFS	SURVEY
SCALE: 1:100		DATE		

PROJECT NO.	E060
DESIGN DWG. NO.	C - 105.1
SHEET #	3

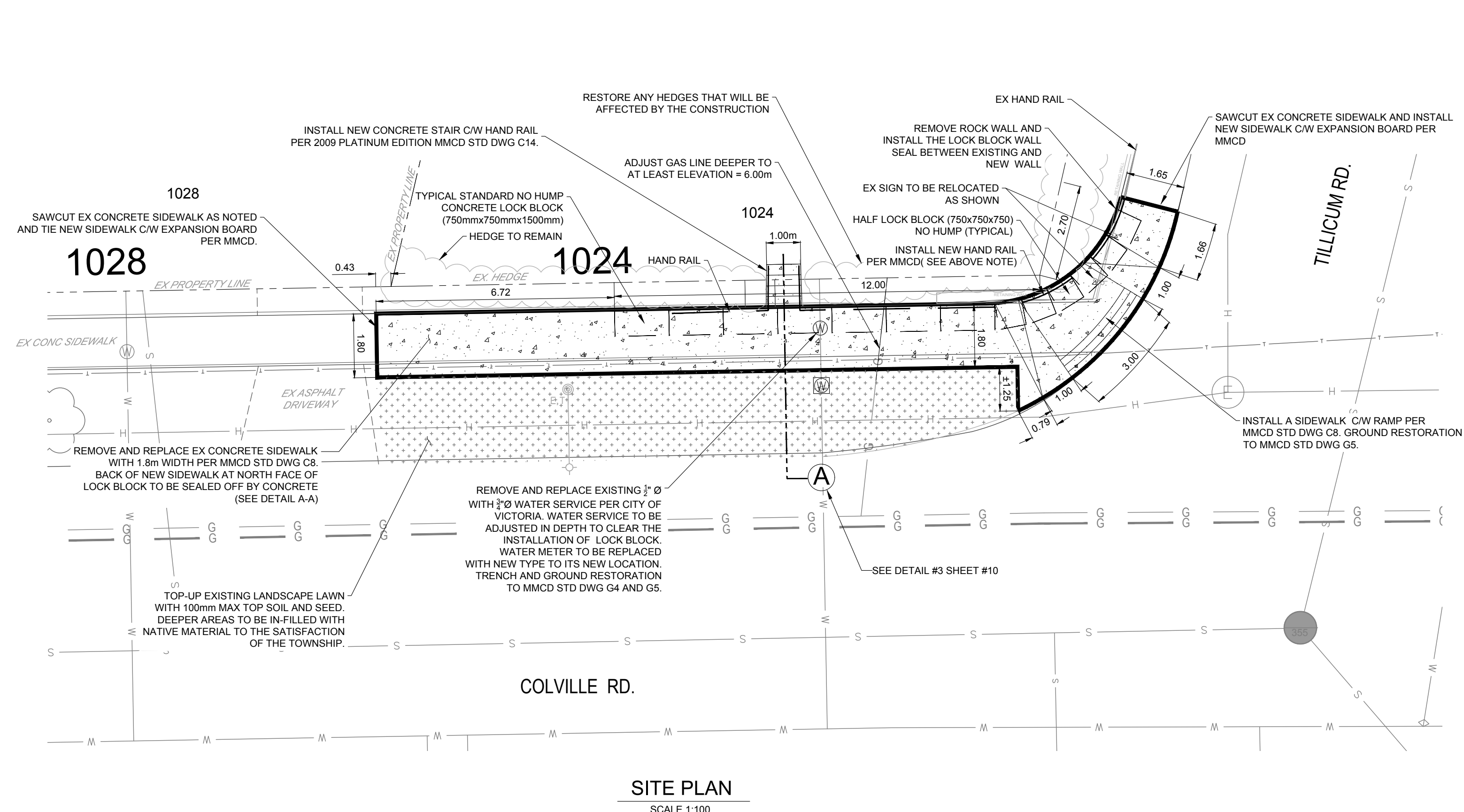

LEGEND:

	PROPOSED SPOT ELEVATION
	PROPOSED TOP OF CURB ELEVATION
	PROPOSED GUTTER LINE ELEVATION
	PROPOSED ELEVATION BOTTOM OF CONCRETE LOCK BLOCK
	EXISTING SPOT ELEVATION

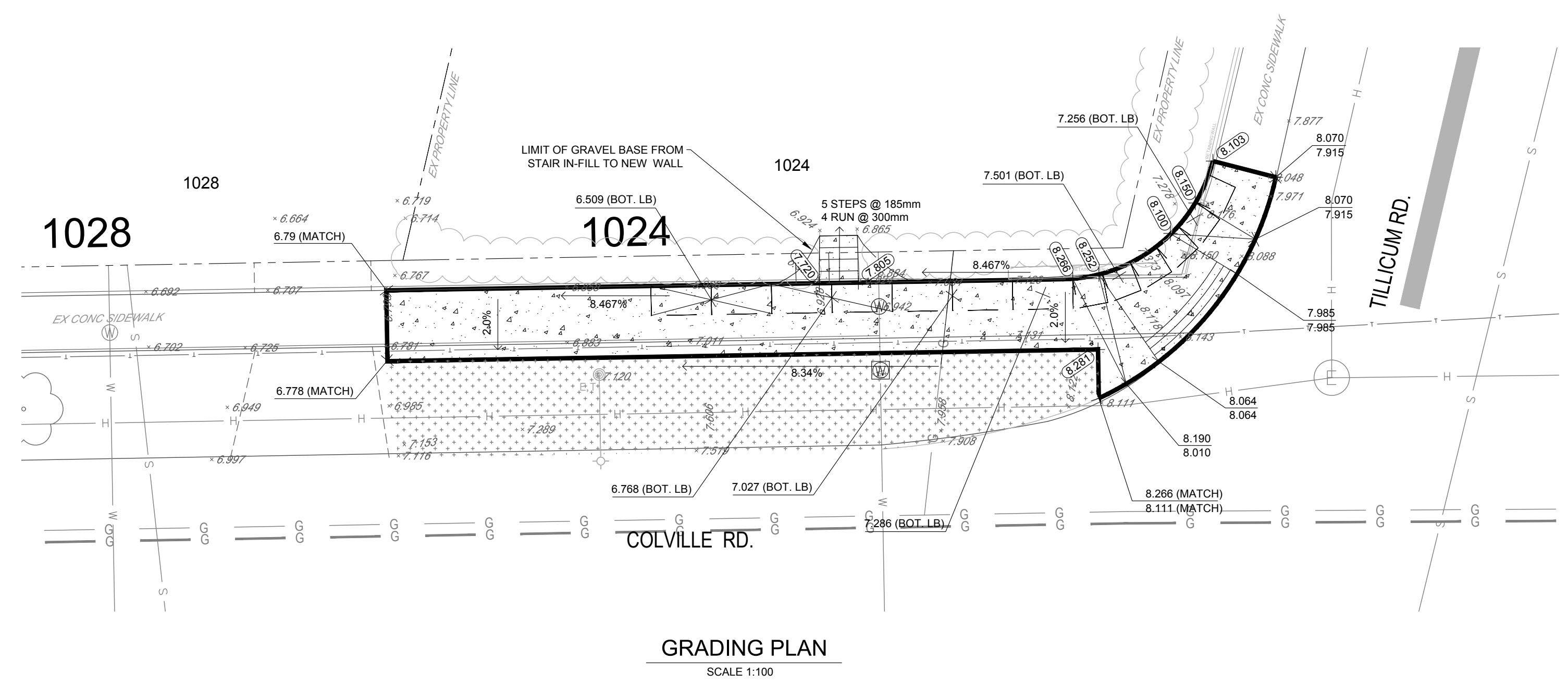

DISCLAIMER:
 LOCATION OF UTILITIES SHOWN ARE APPROXIMATE ONLY AND SHOULD BE CONFIRMED BY FIELD SURVEY AND BY USE OF A PIPE LOCATOR AND MANUAL DIGGING WHERE REQUIRED. EXISTING SERVICE LOCATIONS ARE SHOWN TO INDICATE THE EXISTENCE OF THE SPECIFIED SERVICE ONLY AND ARE NOT NECESSARILY COMPLETE OR SHOWN IN THE CORRECT LOCATION. IT IS THE CONTRACTOR'S RESPONSIBILITY TO LOCATE, VERIFY THE INVERT ELEVATIONS BY HAND EXCAVATION BEFORE CONSTRUCTION OF THE UTILITY CROSSING AND SHALL BE RESPONSIBLE FOR ADEQUATE PROTECTION FROM DAMAGE AT CONTRACTOR'S COST.

CONFIRM UNDERGROUND LOCATIONS WITH UTILITY COMPANIES	LEGEND - Existing services shown solid										REVISIONS			REVISIONS APPROVED			DESIGN APPROVED		TOWNSHIP OF ESQUIMALT VARIOUS CAPITAL PROJECTS 2018 SITE #2 GRADING & PLAN		PROJECT NO.	E060
	CABLE	— TV —	— S/W —	— TREE —	ELECTRIC POLE	TEL POLE	SURVEY MONUMENT	UNDERGROUND	— UC —	ISSUED FOR REVIEW	APP.	DATE	SIGN.	APP.	DATE	SIGN.	APP.	DATE	SIGN.	DESIGN	DWG. NO.	
	DRAIN	— D —	— S/W —	— TREE —	ELECTRIC POLE	TEL POLE	SURVEY MONUMENT	UNDERGROUND	— UC —	ISSUED FOR REVIEW	WW	18.06.15	JM							DESIGN	C - 105.2	
	GAS	— G —	— S/W —	— TREE —	ELECTRIC POLE	TEL POLE	SURVEY MONUMENT	UNDERGROUND	— UC —	ISSUED FOR REVIEW										DESIGN		
SEWER	— S —	— S/W —	— TREE —	ELECTRIC POLE	TEL POLE	SURVEY MONUMENT	UNDERGROUND	— UC —	ISSUED FOR REVIEW										DESIGN			
WATER	— W —	— S/W —	— TREE —	ELECTRIC POLE	TEL POLE	SURVEY MONUMENT	UNDERGROUND	— UC —	ISSUED FOR REVIEW										DESIGN			
ELECTRICAL	— E —	— S/W —	— TREE —	ELECTRIC POLE	TEL POLE	SURVEY MONUMENT	UNDERGROUND	— UC —	ISSUED FOR REVIEW										DESIGN			
										REVISIONS APPROVED			DESIGN APPROVED		CONTROL MONUMENTS DESIGN: EFS DRAWN: EFS SURVEY: EFS SCALES: 1:100		SHEET #	4				

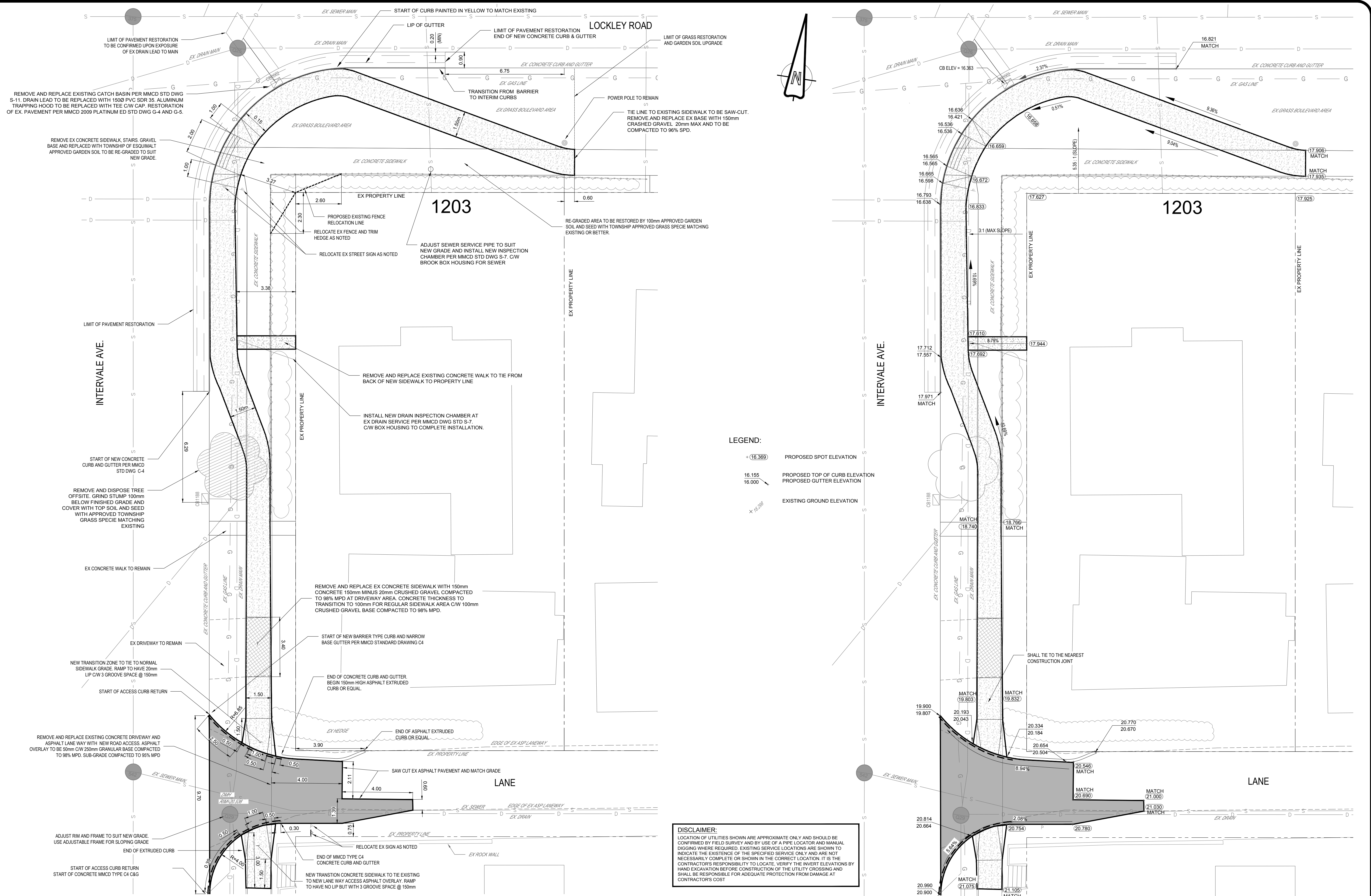

CONFIRM UNDERGROUND LOCATIONS WITH UTILITY COMPANIES	LEGEND - Existing services shown solid										REVISIONS			REVISIONS APPROVED			DESIGN APPROVED			TOWNSHIP OF ESQUIMALT VARIOUS CAPITAL PROJECTS 2018		PROJECT NO. E060
	DRAIN — D — GAS — G — SEWER — S — WATER — W — ELECTRICAL — E —	SIDEWALK — S/W — DRAIN MANHOLE — DM — GAS VALVE — GV — SEWER MANHOLE — SM — WATER VALVE — WV —	S/W CATCH BASIN — CB — GAS SNIFFER — GS — HYDRO MANHOLE — HM — FIRE HYDRANT — FH —	TREE — T — ELECTRIC POLE — EP — TEL POLE — TP — DRAIN CLEANOUT — DC — GAS METER — GM — SEWER CLEANOUT — SC — WATER METER — WM —	SURVEY MONUMENT — SM — UNDERGROUND — UG — LAWN BASIN — LB — STREET LIGHT — SL — TEL MANHOLE — TM — UTILITY CAP — UC —	ISSUED FOR REVIEW	REVISION 1 APP. DATE SIGN WW 18.06.15 JM	REVISION 2 APP. DATE SIGN WW 18.03.30 JM	REVISION 3 APP. DATE SIGN WW 18.03.30 JM	EXCEPTIONS APPROVED BY DATE SIGN DESIGN ENG. WW 18.03.30 WW	ASSIST. ENG. MUNICIPAL ENG. 18.03.30 JM	CONTROL MONUMENTS DESIGN EFS DRAWN EFS SURVEY DATE	SCALES 1:100	SHEET NO. 5								
	CONFIRM UNDERGROUND LOCATIONS WITH UTILITY COMPANIES												DESIGN APPROVED		PROJECT NO. E060							

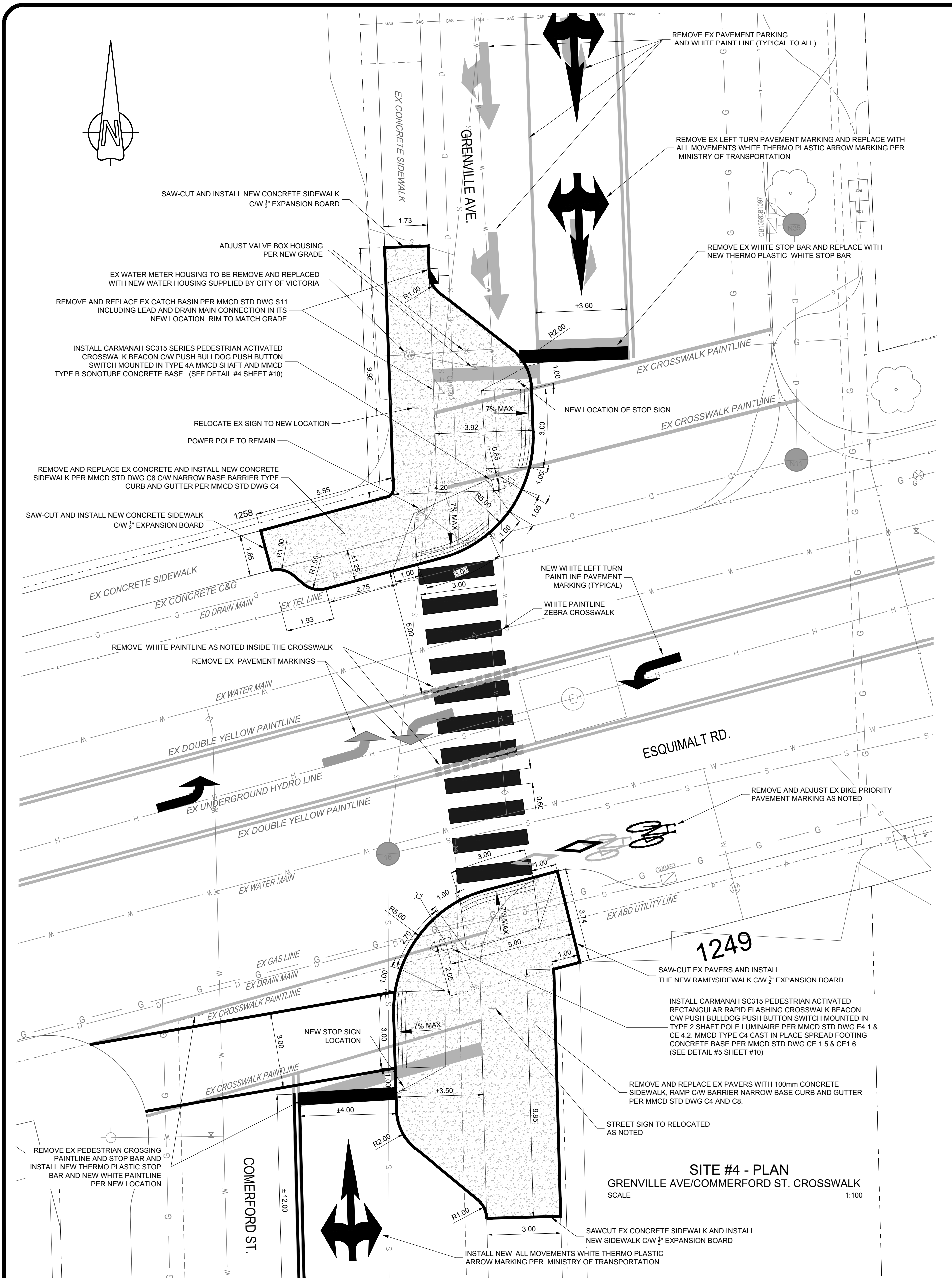

SITE #4 - PLAN
 GRENVILLE AVE/COMMERFORD ST. CROSSWALK
 SCALE 1:100

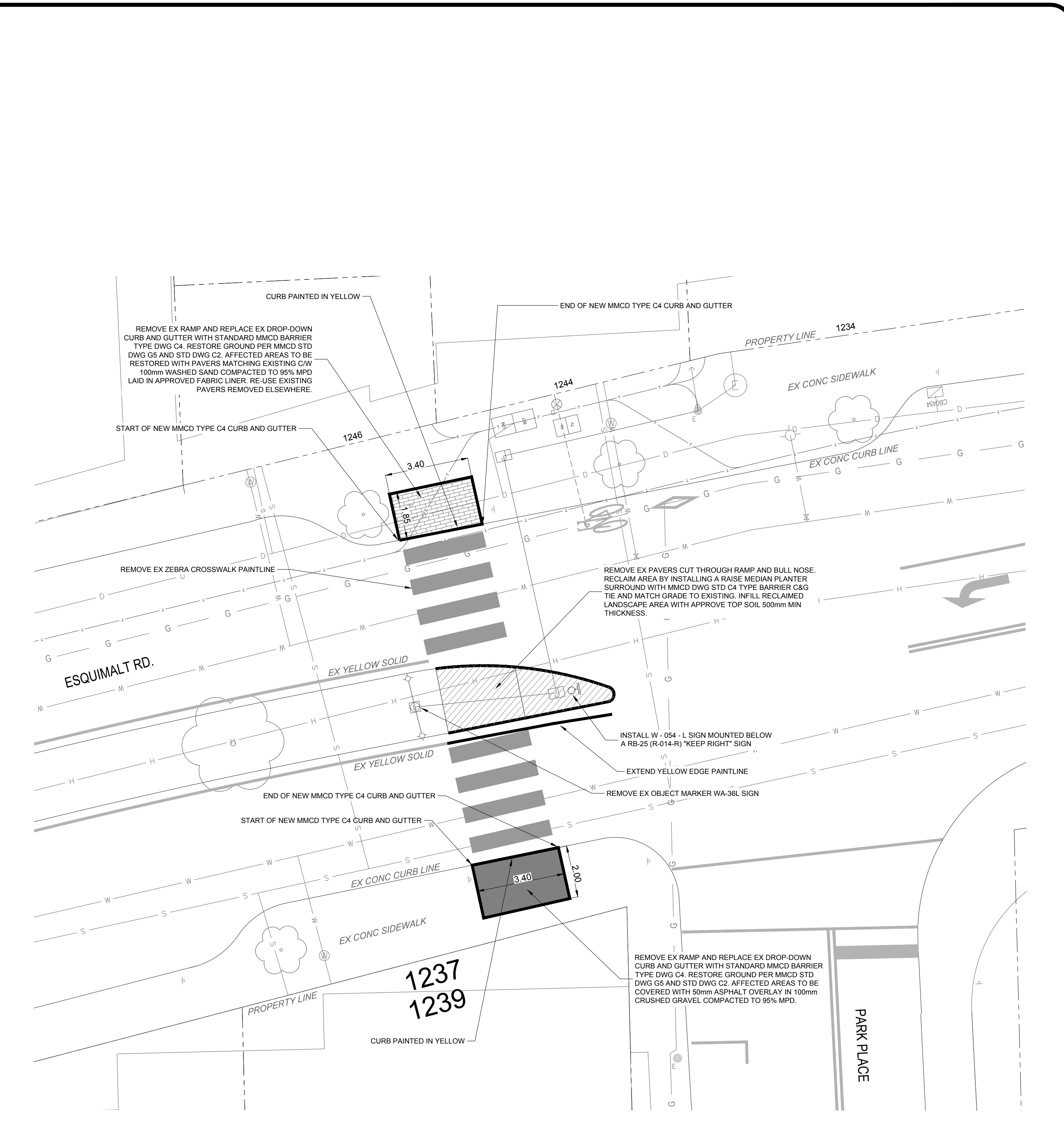

SITE #5 - PLAN
 EXISTING CROSSING TO BE REMOVED
 PARK PL. CROSSWALK
 SCALE 1:100

DISCLAIMER:
 LOCATION OF UTILITIES SHOWN ARE APPROXIMATE ONLY AND SHOULD BE CONFIRMED BY FIELD SURVEY AND BY USE OF A PIPE LOCATOR AND MANUAL DIGGING WHERE REQUIRED. EXISTING SERVICE LOCATIONS ARE SHOWN TO INDICATE THE EXISTENCE OF THE SPECIFIED SERVICE ONLY AND ARE NOT NECESSARILY COMPLETE OR SHOWN IN THE CORRECT LOCATION. IT IS THE CONTRACTOR'S RESPONSIBILITY TO LOCATE, VERIFY THE INVERT ELEVATIONS BY HAND EXCAVATION BEFORE CONSTRUCTION OF THE UTILITY CROSSING AND SHALL BE RESPONSIBLE FOR ADEQUATE PROTECTION FROM DAMAGE AT CONTRACTOR'S COST.

CONFIRM UNDERGROUND LOCATIONS WITH UTILITY COMPANIES

LEGEND - Existing services shown solid											
DRAIN	— D —	SIDEWALK	S/W	TREE	⊙	ELECTRIC POLE	⊕	TEL POLE	⊕	SURVEY MONUMENT	⊕
GAS	— G —	DRAIN MANHOLE	⊙	CATCH BASIN	⊙	DRAIN CLEANOUT	⊙	LAWN BASIN	⊙	UNDERGROUND - UG	— UG —
SEWER	— S —	GAS VALVE	⊙	GAS SNIFFER	⊙	GAS METER	⊙	STREET LIGHT	⊙	TEL	— T —
WATER	— W —	SEWER MANHOLE	⊙	HYDRO MANHOLE	⊙	SEWER CLEANOUT	⊙	CHAMBER	⊙	TEL MANHOLE	⊙
ELECTRICAL	— E —	WATER VALVE	⊙	FIRE HYDRANT	⊙	WATER METER	⊙	UTILITY CAP	⊙	DITCH LINE	— DL —

REVISIONS		REVISIONS APPROVED				DESIGN APPROVED		TOWNSHIP OF ESQUIMALT VARIOUS CAPITAL PROJECTS 2018				PROJECT NO.
NO.	DESCRIPTION	APP.	DATE	SIGN.	APP.	DATE	SIGN.	EXCEPTIONS	DATE	SIGN.	DESIGN	DWG. NO.
1	ISSUED FOR REVIEW	WW	18.06.15	JM					18.03.30	WW	C-105.4	
		DESIGN ENG.			CONTROL MONUMENTS						SHEET #	
		ASSIST. ENG.			DESIGN: EFS						6	
		MUNICIPAL ENG.	18.03.30	JM	SCALE: 1:100							

80657

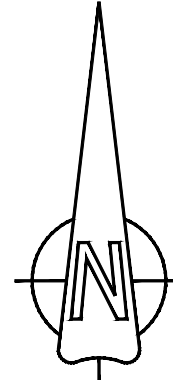





DISCLAIMER:
 LOCATION OF UTILITIES SHOWN ARE APPROXIMATE ONLY AND SHOULD BE CONFIRMED BY FIELD SURVEY AND BY USE OF A PIPE LOCATOR AND MANUAL DIGGING WHERE REQUIRED. EXISTING SERVICE LOCATIONS ARE SHOWN TO INDICATE THE EXISTENCE OF THE SPECIFIED SERVICE ONLY AND ARE NOT NECESSARILY COMPLETE OR SHOWN IN THE CORRECT LOCATION. IT IS THE CONTRACTOR'S RESPONSIBILITY TO LOCATE, VERIFY THE INVERT ELEVATIONS BY HAND EXCAVATION BEFORE CONSTRUCTION OF THE UTILITY CROSSING AND SHALL BE RESPONSIBLE FOR ADEQUATE PROTECTION FROM DAMAGE AT CONTRACTOR'S COST.

SITE PLAN 1
 1200 ESQUIMALT RD. CROSSWALK
 SCALE 1:200

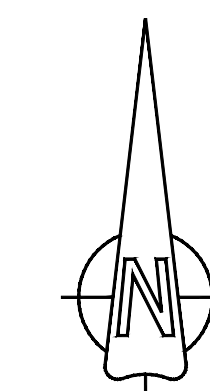
CONFIRM UNDERGROUND LOCATIONS WITH UTILITY COMPANIES	LEGEND - Existing services shown solid																																			
	CABLE — TV —	SIDEWALK	S/W TREE	ELECTRIC POLE	TEL POLE	SURVEY MONUMENT	DRAIN	DRAIN MANHOLE	CATCH BASIN	DRAIN CLEANOUT	LAWN BASIN	UNDERGROUND - UG	SEWER	GAS VALVE	GAS SNIFFER	GAS METER	STREET LIGHT	WATER	SEWER MANHOLE	HYDRO MANHOLE	SEWER CLEANOUT	DRAIN/SEWER INSP. CHAMBER	TEL MANHOLE	ELECTRICAL	WATER VALVE	FIRE HYDRANT	WATER METER	UTILITY CAP	DITCH LINE							
	REVISIONS	REVISIONS APPROVED																																		
ISSUED FOR REVIEW															REVISION 1			REVISION 2			REVISION 3			DESIGN APPROVED			PROJECT NO.	E060								
APPROVED BY: WW															APP. DATE: 18.06.15			SIGN: JM			EXCEPTIONS:			DATE: 18.03.30			SIGN: WW			DESIGN	C - 105.5					
MUNICIPAL ENG.															MUNICIPAL ENG.			MUNICIPAL ENG.			MUNICIPAL ENG.			MUNICIPAL ENG.			MUNICIPAL ENG.			CONTROL MONUMENTS	Sheet #		7			
MUNICIPAL ENG.															MUNICIPAL ENG.			MUNICIPAL ENG.			MUNICIPAL ENG.			MUNICIPAL ENG.			MUNICIPAL ENG.			MUNICIPAL ENG.			1:125		DATE	

TOWNSHIP OF ESQUIMALT														
VARIOUS CAPITAL PROJECTS 2018														
SITE #6 PLAN														
SCALE 1:125														

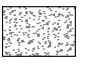

- LEGEND:**
-  EXISTING TREE
 -  NEW CONCRETE DRIVEWAY 150mm THICK CONCRETE
 -  NEW CONCRETE SIDEWALK 100mm THICK CONCRETE
 -  TRANSITION ZONE FROM NEW TO EXISTING CONCRETE

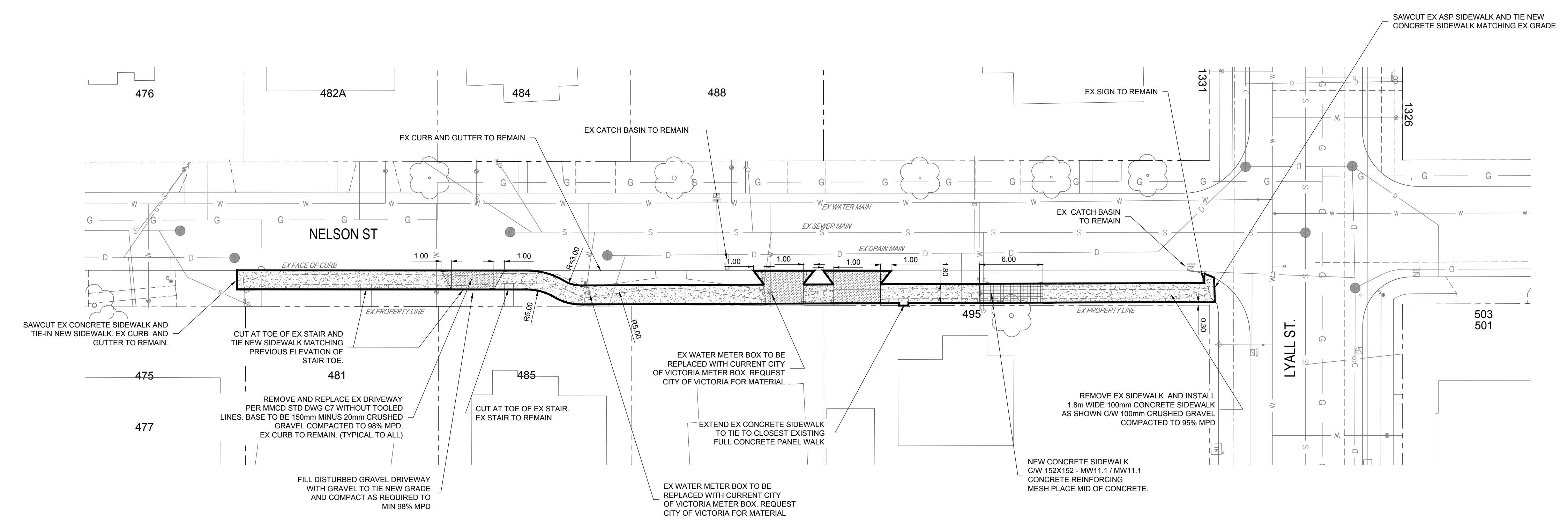

DISCLAIMER:
 LOCATION OF UTILITIES SHOWN ARE APPROXIMATE ONLY AND SHOULD BE CONFIRMED BY FIELD SURVEY AND BY USE OF A PIPE LOCATOR AND MANUAL DIGGING WHERE REQUIRED. EXISTING SERVICE LOCATIONS ARE SHOWN TO INDICATE THE EXISTENCE OF THE SPECIFIED SERVICE ONLY AND ARE NOT NECESSARILY COMPLETE OR SHOWN IN THE CORRECT LOCATION. IT IS THE CONTRACTOR'S RESPONSIBILITY TO LOCATE, VERIFY THE INVERT ELEVATIONS BY HAND EXCAVATION BEFORE CONSTRUCTION OF THE UTILITY CROSSING AND SHALL BE RESPONSIBLE FOR ADEQUATE PROTECTION FROM DAMAGE AT CONTRACTOR'S COST

CONFIRM UNDERGROUND LOCATIONS WITH UTILITY COMPANIES

LEGEND - Existing services shown solid	
CABLE — TV —	SIDEWALK S/W TREE
DRAIN — D —	CATCH BASIN
GAS — G —	DRAIN CLEANOUT DC
SEWER — S —	GAS VALVE
WATER — W —	SEWER MANHOLE
ELECTRICAL — E —	WATER VALVE
	FIRE HYDRANT
	WATER METER
	UTILITY CAP
	DITCH LINE
	TEL POLE
	LAWN BASIN
	STREET LIGHT
	DRAIN/SEWER INSP CHAMBER
	TEL MANHOLE
	SURVEY MONUMENT
	UNDERGROUND — UG —
	TEL — T —

REVISIONS	
ISSUED FOR REVIEW	

REVISIONS APPROVED					
REVISION 1	REVISION 2	REVISION 3	EXCEPTIONS	DATE	SIGN
APP. DATE SIGN	APP. DATE SIGN	APP. DATE SIGN	APPROVED BY	18.03.30	WW
WW 18.06.15 JM			DESIGN ENG.		
			ASSIST. ENG.		
			MUNICIPAL ENG.	18.03.30	JM

DESIGN APPROVED	
APPROVED BY	18.03.30 WW
DESIGN ENG.	
ASSIST. ENG.	
MUNICIPAL ENG.	18.03.30 JM

TOWNSHIP OF ESQUIMALT
 VARIOUS CAPITAL PROJECTS 2018
 SITE #7 PLAN
 CONTROL MONUMENTS
 DESIGN: EFS DRAWN: EFS SURVEY: DATE: SCALE: 1:100

PROJECT NO.	E060
DESIGN DWG. NO.	C-105.6
SHEET #	8

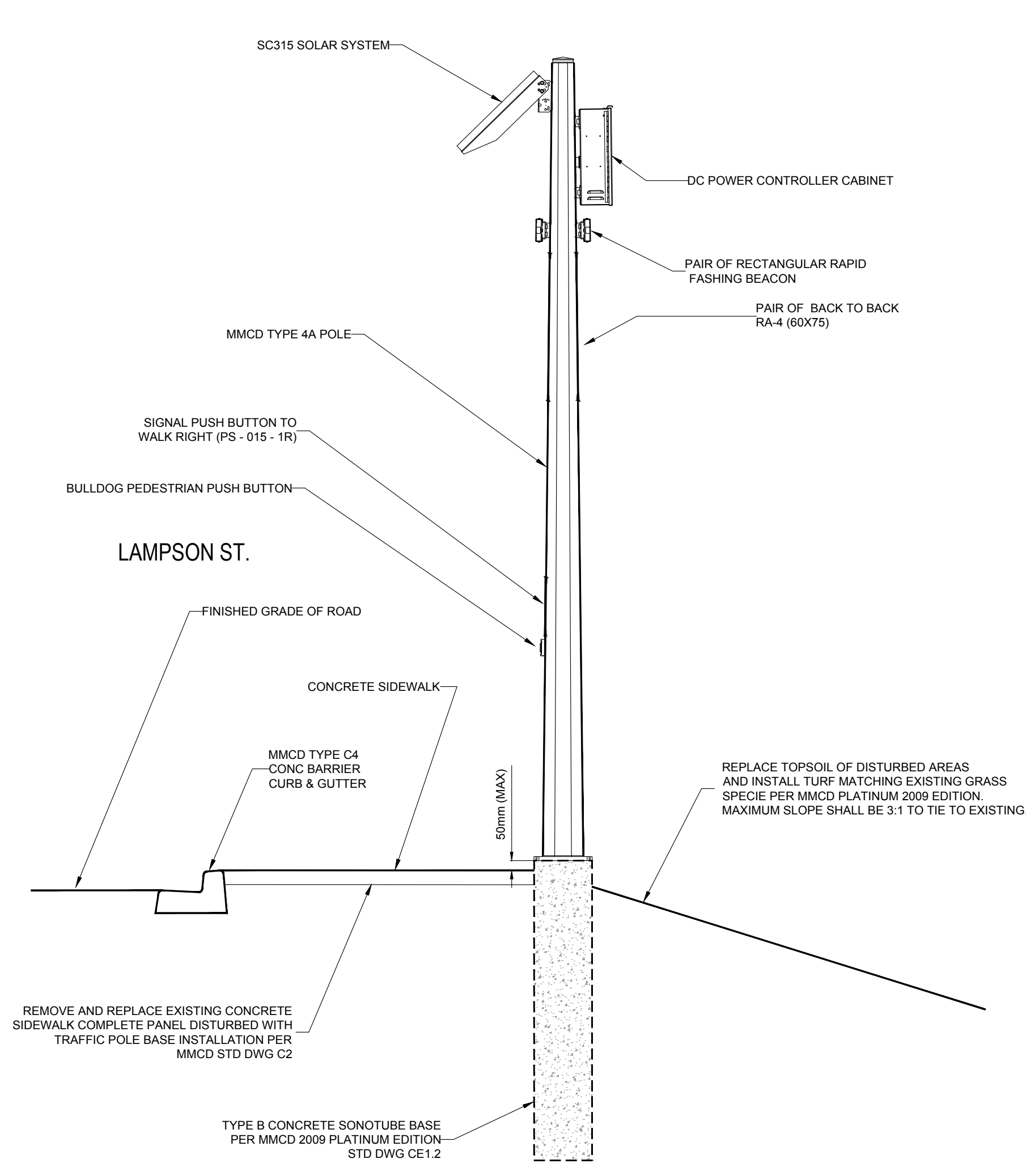

DETAIL 1
PEDESTRIAN OVERHEAD CONTROLLED
CROSSWALK LIGHT
SCALE N.T.S.

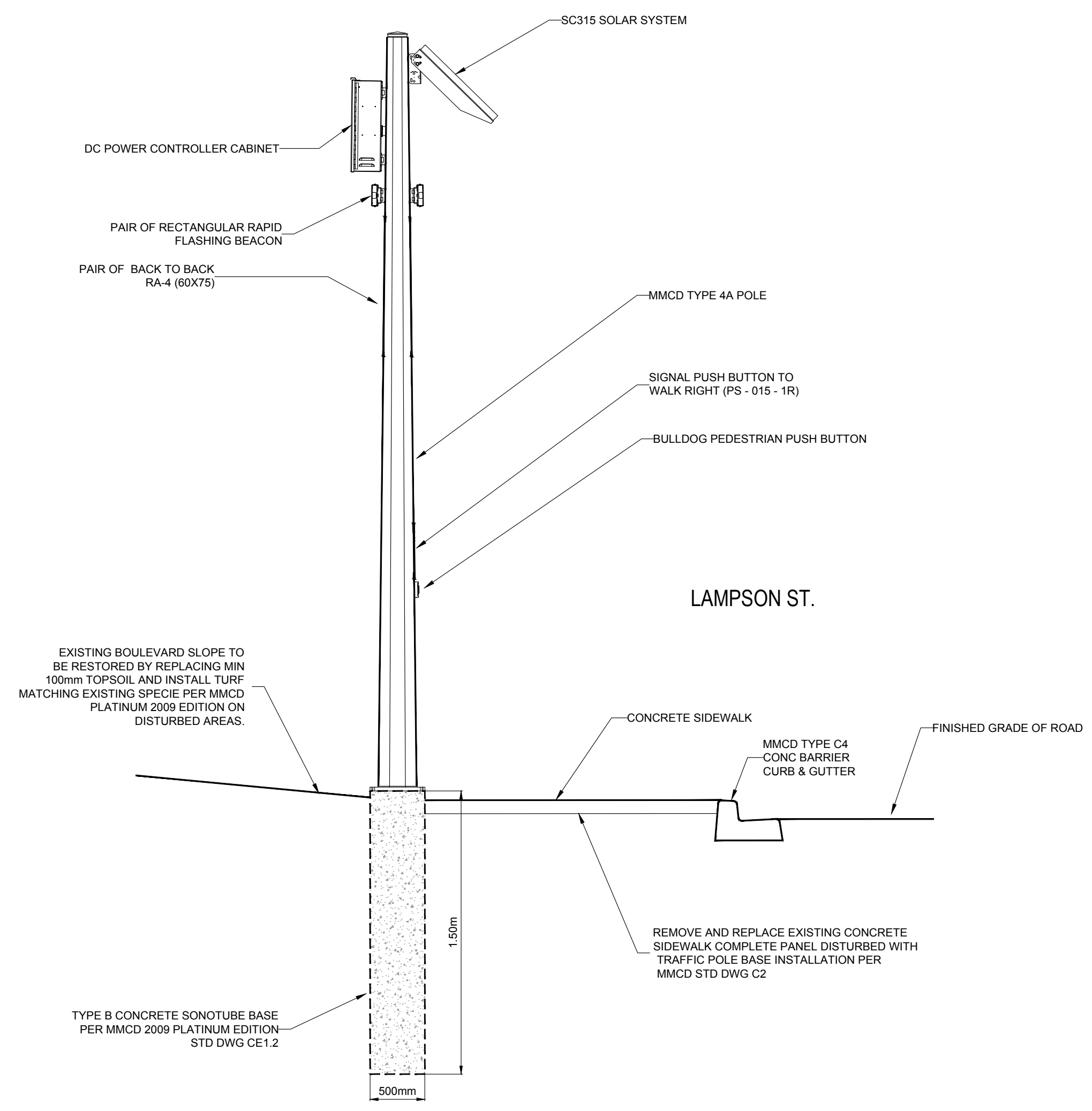

DETAIL 2
PEDESTRIAN OVERHEAD CONTROLLED
CROSSWALK LIGHT
SCALE N.T.S.

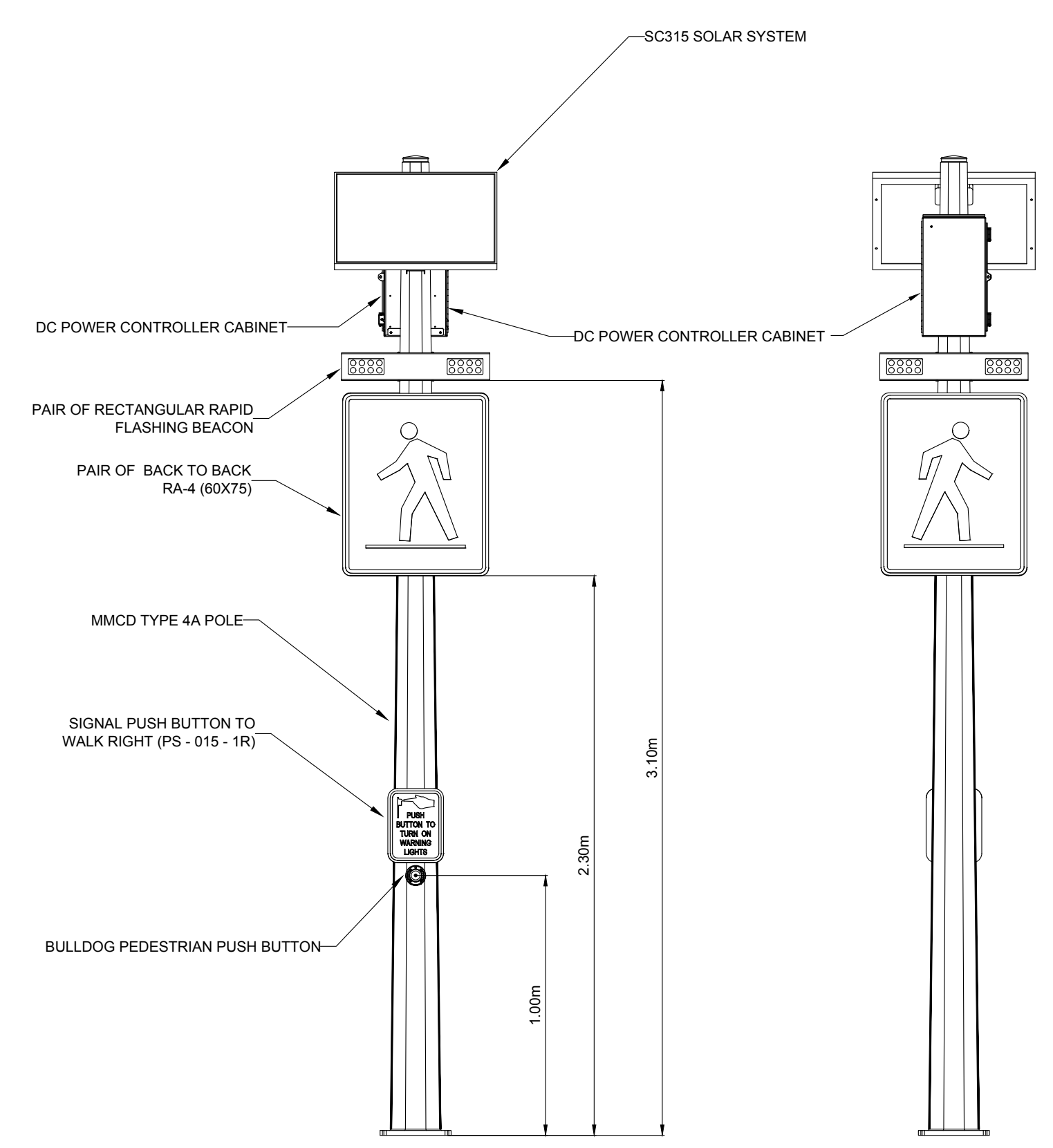

DETAIL 3
ELEVATION DRAWINGS FOR PEDESTRIAN
CROSSWALK LIGHT POLES
SCALE N.T.S.

CONFIRM
UNDERGROUND
LOCATIONS WITH
UTILITY COMPANIES

LEGEND - Existing services shown solid	
CABLE — TV —	TEL POLE
DRAIN — D —	UNDERGROUND — UG —
GAS — G —	TEL MANHOLE
SEWER — S —	TEL MANHOLE
WATER — W —	TEL MANHOLE
ELECTRICAL — E —	TEL MANHOLE
SEWER MANHOLE	TEL MANHOLE
WATER VALVE	TEL MANHOLE
FIRE HYDRANT	TEL MANHOLE
WATER METER	TEL MANHOLE
UTILITY CAP	TEL MANHOLE
DITCH LINE	TEL MANHOLE

REVISIONS		REVISIONS APPROVED			DESIGN APPROVED	
NO.	DATE	APP.	DATE	SIGN.	DATE	SIGN.
1	18.06.15	JM				
ISSUED FOR REVIEW						

TOWNSHIP OF ESQUIMALT			
VARIOUS CAPITAL PROJECTS 2018			
DETAIL PLAN #1			
DESIGN	ENGINEER	DATE	SIGN.
ASSIST. ENG.	DATE	SIGN.	
MUNICIPAL ENG.	DATE	SIGN.	
DESIGN	ENGINEER	DATE	SIGN.
ASSIST. ENG.	DATE	SIGN.	
MUNICIPAL ENG.	DATE	SIGN.	

PROJECT NO.	E060
DESIGN DWG. NO.	C - 801
SHEET #	9

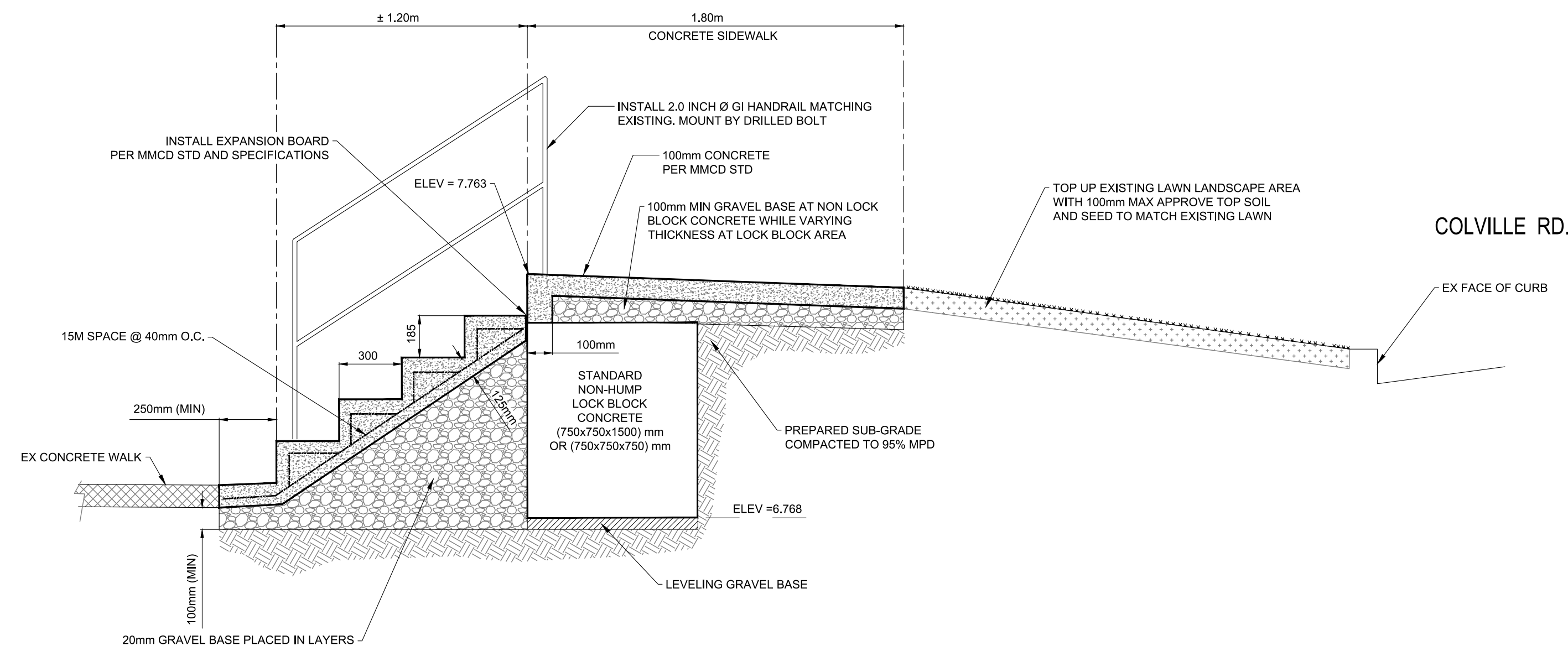

DETAIL #3
SECTION DETAIL A-A
AS SHOWN

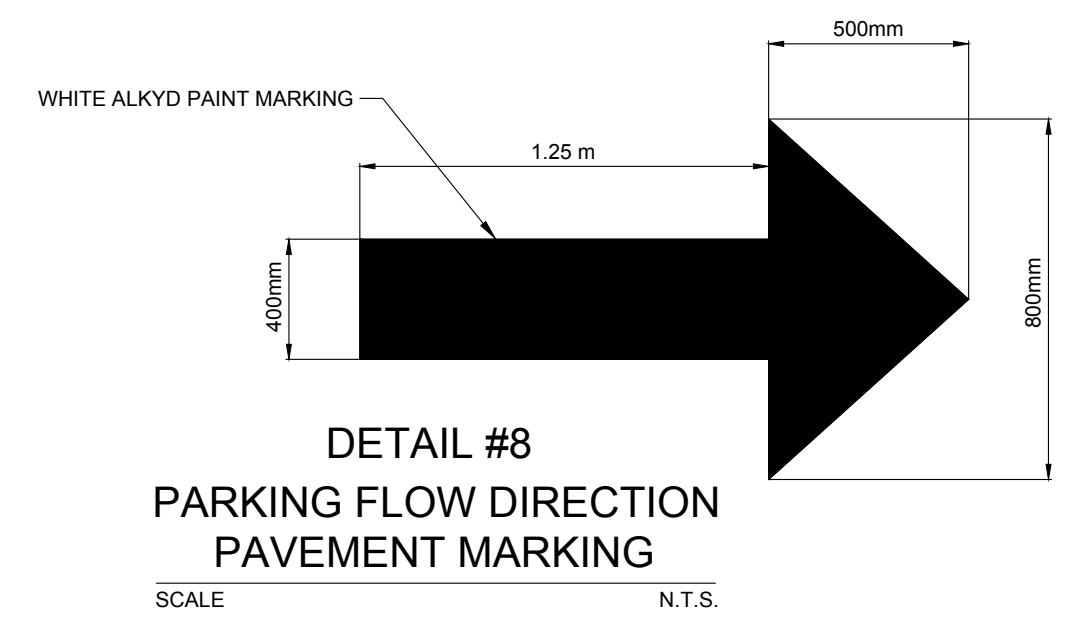

DETAIL #8
PARKING FLOW DIRECTION PAVEMENT MARKING
SCALE N.T.S.

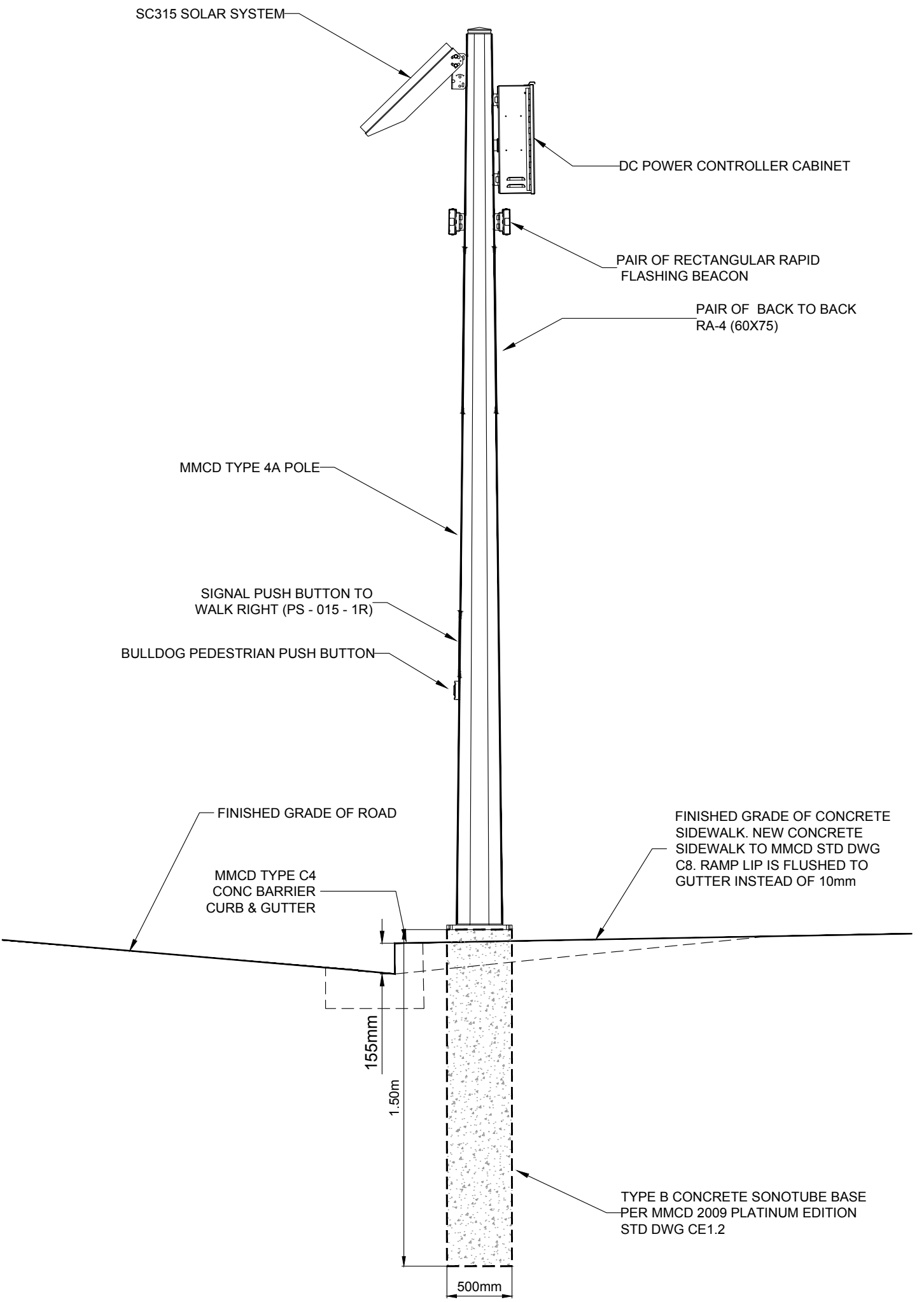

DETAIL #4
PEDESTRIAN CONTROLLED CROWWALK LIGHT
SCALE N.T.S.

ALL DRAWINGS AND PARTS LIST TO COMPLY WITH MMCD STD DWG CE1.5, CE1.6, CE1.7, E4.1 & E4.2 UNLESS OTHERWISE NOTED. EXCEPT LUMINAIRE REPLACE W/ LED 40B LIGHT ASSEMBLY (SEE DETAIL)

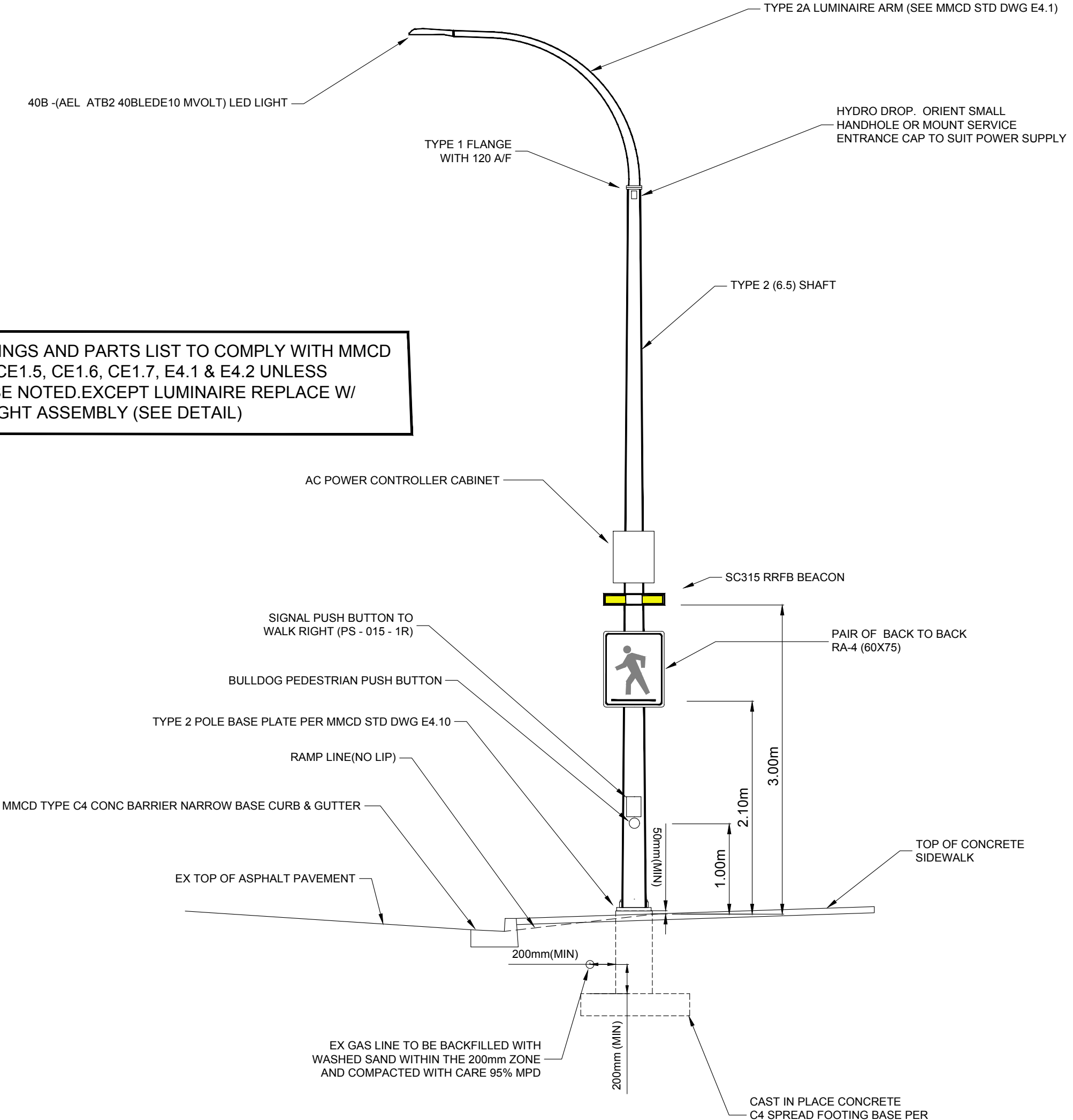

DETAIL 5
STREET AND TRAFFIC LIGHT
SCALE N.T.S.



W - 054 - L
OBJECT MARKER



PS - 002
PEDESTRIAN CROSSING AHEAD SIGN

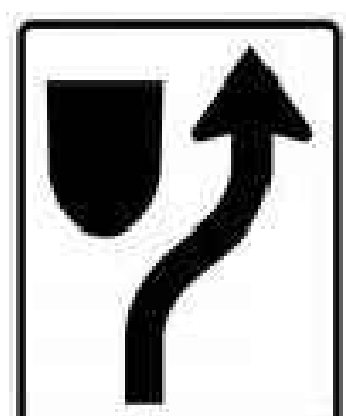

R - 014 - R
KEEP RIGHT SIGN MEDIAN/ISLAND LEFT



PS-015-1R
SIGNAL PUSH BUTTON TO WALK RIGHT ARROW



PS-015-1L
SIGNAL PUSH BUTTON TO WALK RIGHT ARROW

CONFIRM UNDERGROUND LOCATIONS WITH UTILITY COMPANIES

LEGEND - Existing services shown solid	
CABLE - C -	SEWER MANHOLE - S -
DRAIN - D -	WATER VALVE - W -
GAS - G -	WATER VALVE - W -
SEWER - S -	WATER VALVE - W -
WATER - W -	WATER VALVE - W -
ELECTRICAL - E -	WATER VALVE - W -

REVISIONS	
ISSUED FOR REVIEW	

REVISIONS APPROVED	
REVISION 1	REVISION 2
REVISION 3	

DESIGN APPROVED	
APPROVED BY	DATE
DESIGN ENG.	18.03.30
ASSIST. ENG.	
MUNICIPAL ENG.	18.03.30

TOWNSHIP OF ESQUIMALT			
VARIOUS CAPITAL PROJECTS 2018			
DETAIL PLAN #2			
DESIGN	EFB	DRAWN	EFB
CONTROL MONUMENTS			
SCALE	AS SHOWN		

PROJECT NO.	DESIGN DWG. NO.	SHEET #
E060	C - 802	10

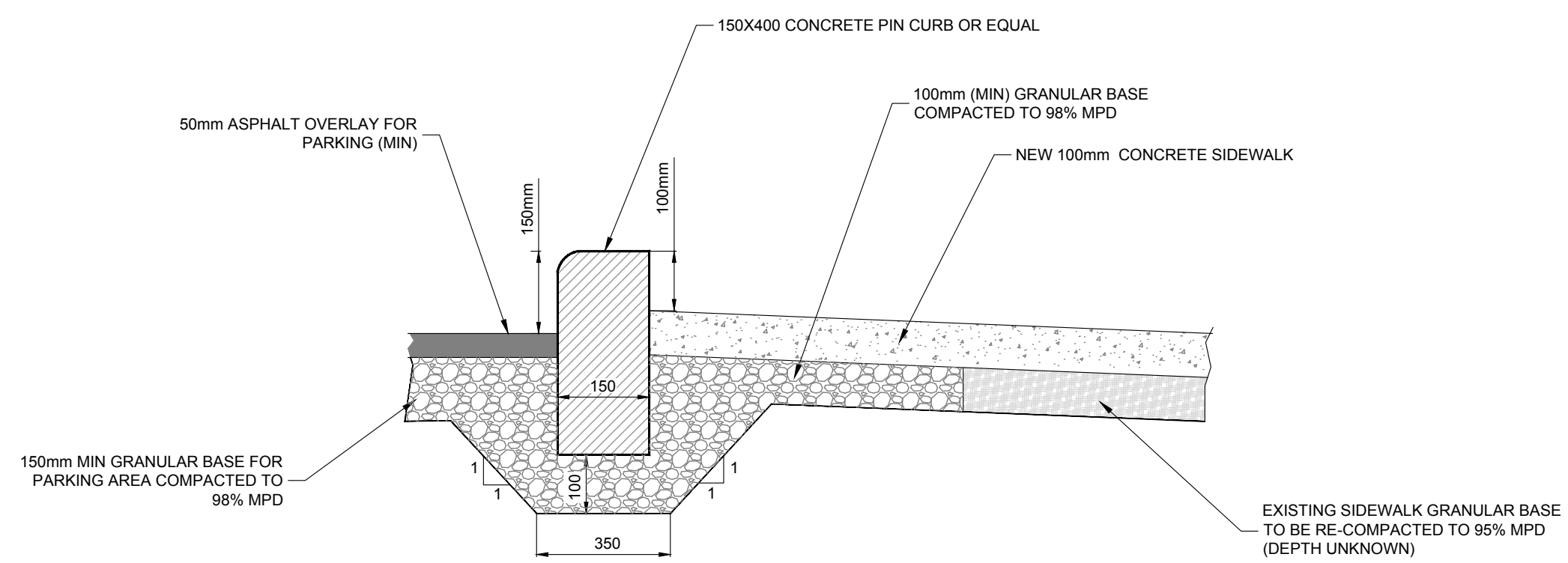

DETAIL #7
SECTION B-B
SCALE N.T.S.

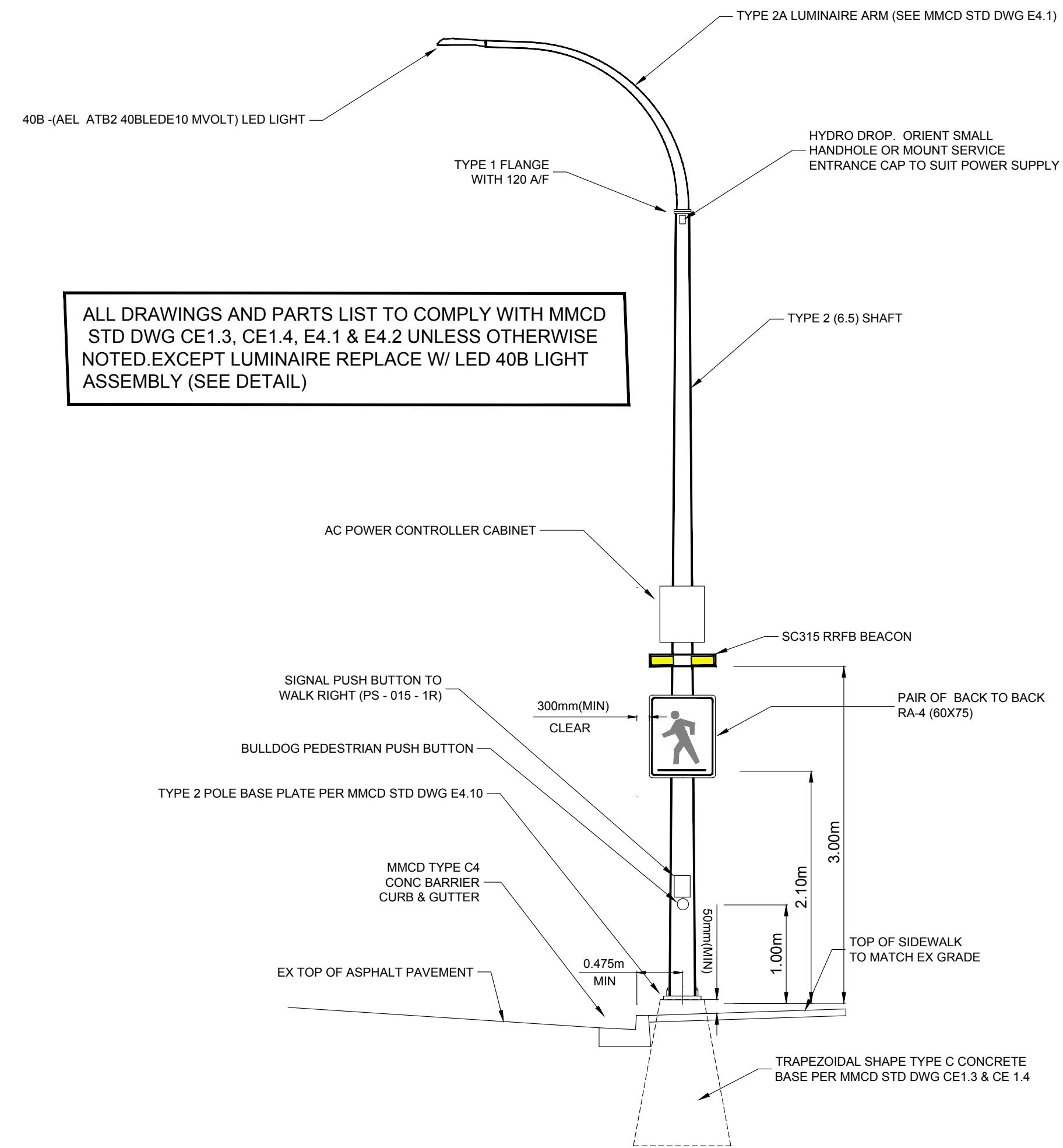

ALL DRAWINGS AND PARTS LIST TO COMPLY WITH MMCD STD DWG CE1.3, CE1.4, E4.1 & E4.2 UNLESS OTHERWISE NOTED. EXCEPT LUMINAIRE REPLACE W/ LED 40B LIGHT ASSEMBLY (SEE DETAIL)

DETAIL #6
STREET AND TRAFFIC LIGHT
SCALE N.T.S.

CONFIRM UNDERGROUND LOCATIONS WITH UTILITY COMPANIES	CABLE — C —	LEGEND — Existing services shown solid										REVISIONS			REVISIONS APPROVED			DESIGN APPROVED		<i>TOWNSHIP OF ESQUIMALT</i>			PROJECT NO.	E060		
	DRAIN — D —	SIDEWALK	S/W TREE	ELECTRIC POLE	TEL POLE	SURVEY MONUMENT	ISSUED FOR REVIEW			APP.	DATE	SIGN.	APP.	DATE	SIGN.	APP.	DATE	SIGN.	EXCEPTIONS	DATE	SIGN.	VARIOUS CAPITAL PROJECTS 2018			DESIGN DWG. NO.	C - 803
	GAS — G —	DRAIN MANHOLE	CATCH BASIN	DRAIN CLEANOUT	LAWN BASIN	UNDERGROUND — UG —				JM	18.06.15								APPROVED BY	18.03.30	WW	DETAIL PLAN #3			CONTROL MONUMENTS	
	SEWER — S —	GAS VALVE	GAS SNIFTER	GAS METER	STREET LIGHT	TEL — T —													DESIGN ENG.			CONTROL MONUMENTS			Sheet #	11
	WATER — W —	SEWER MANHOLE	HYDRO MANHOLE	SEWER CLEANOUT	DRAIN/SEWER INSP CHAMBER	TEL MANHOLE													ASSIST. ENG.			DESIGN: EFS	DRAWN: EFS	SURVEY		
ELECTRICAL — E —	WATER VALVE	FIRE HYDRANT	WATER METER	UTILITY CAP	DITCH LINE													MUNICIPAL ENG.	18.03.30	JM	SCALE: AS SHOWN					